

# FARM PLANS

VOLUME 1



## 20 Detailed Plans

Including a variety of tool sheds, farm shops  
and agribusiness buildings







I hope you enjoy your Farm Buildings Plan Book Vol. 1 from FBi Buildings.

This plan book was created to be a helpful resource to you as you begin the planning process of your new farm building. Our goal is to make it easy to plan, buy, build, and own the right building for you. One of the best ways to start the planning process is to look at what others have done.

These plans represent a wide range of applications, from simple tool sheds to large farm operation hubs which combine shop, storage and office space. Our customers have told us they enjoy seeing this variety because much can be gleaned from buildings of various sizes and styles. I hope you agree.

If you have site issues that need consideration – and almost everyone does – you may want to request our free Site Planning Kit. It's one more tool we provide to help you plan for success.

No matter where you are in the planning process, feel free to give us a call at 1-800-552-2981. Our team stands ready to assist with design/engineering, permits, pricing – whatever it takes to help you maximize the value of your building investment while moving your project from a dream to your reality.

Sincerely,

A handwritten signature in black ink that reads "Miles Ridgway". The script is fluid and cursive, with the first letter of each word being capitalized and larger than the others.

Miles Ridgway  
President, FBi Buildings









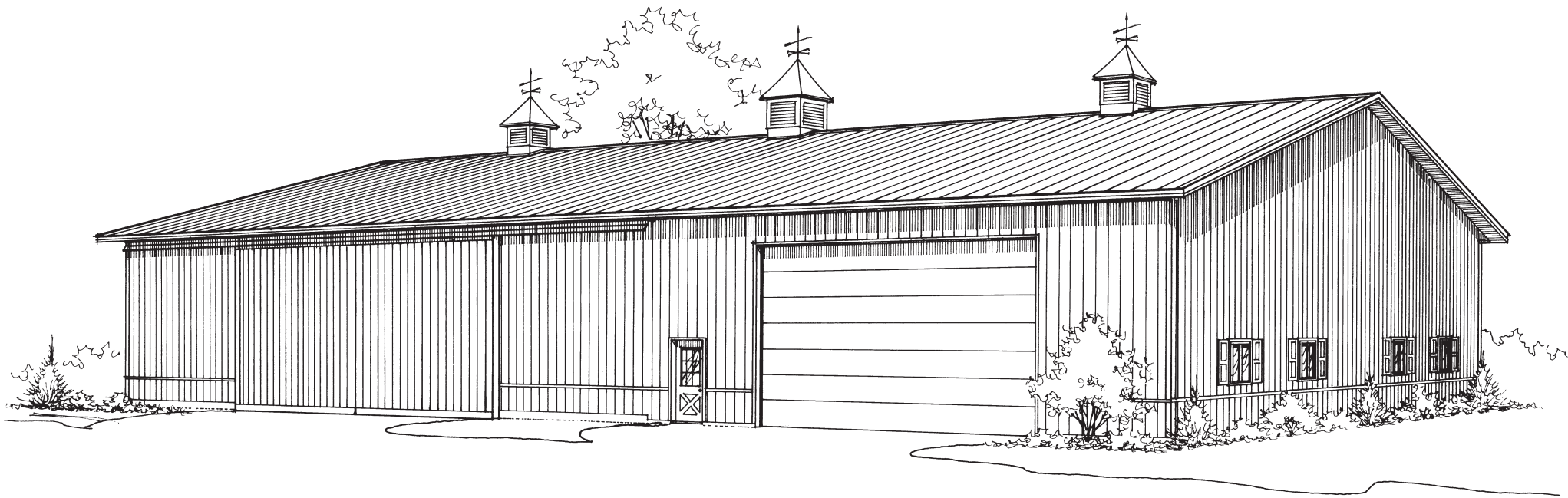

# Heritage Place



**SIMPLE, BUT CLASSIC DESIGN,** is an excellent balance of economy, functionality and style. This shed will still be serving you well and looking good when the next generation moves onto the home place. This plan showcases a popular layout with 2/3 cold storage and 1/3 heated shop, both accessed from the front. Having just two (large) doors keeps costs down and makes this layout work especially well when you need to place your building between existing structures.





simple, but classic design

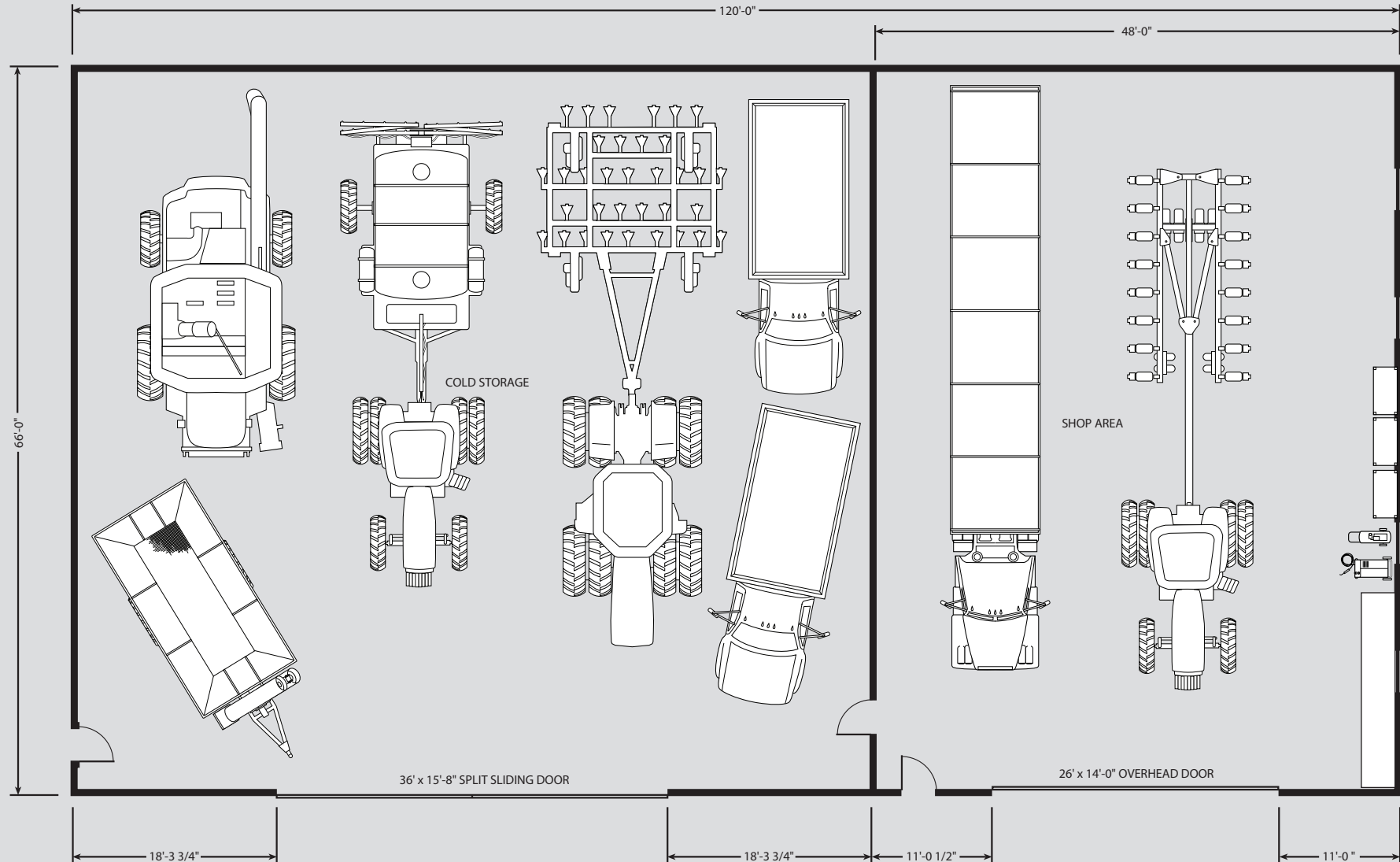



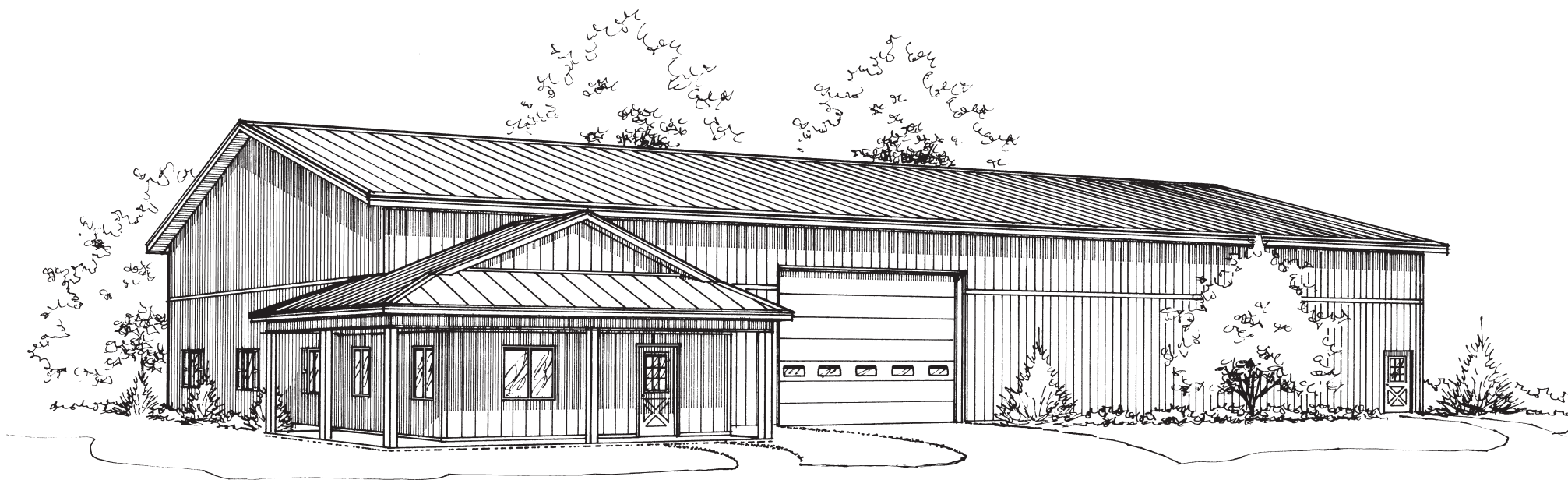

# Agribusiness Plus

## TAKE YOUR SEED DEALERSHIP TO THE NEXT LEVEL

with a building designed to draw attention and accommodate customers. Set yourself apart from the small seed dealers. Striking design features, such as a high accent stripe and a wrap around porch with a Dutch hip roof, give this building impressive curb appeal. Looks so good, you'll want to put it in a prominent location. Inside is a full office with storage above, workshop and plenty of room for seed storage and handling.





take your seed business to the next level

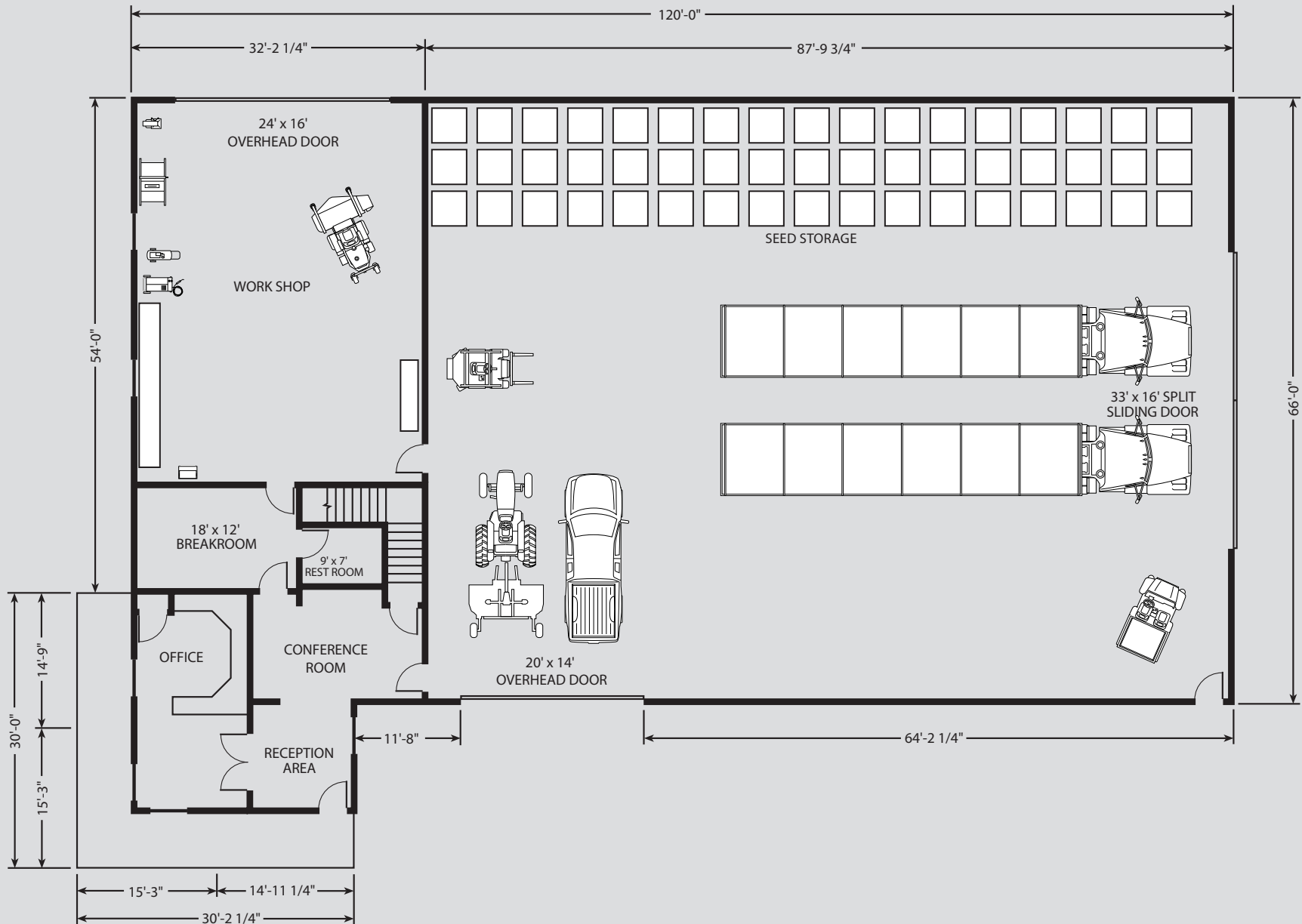



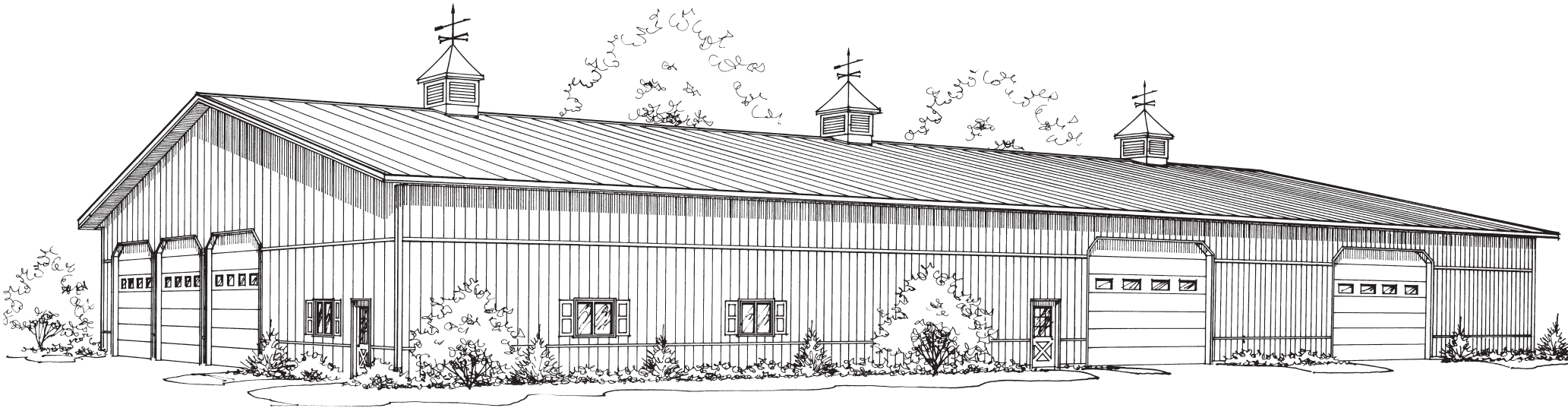

# Longtime Leader

## PUTS ITS BEST FACE FORWARD

This is a serious farm building, but viewed from the house and the road, it presents a more classy—almost residential—look. Your wife will approve. That's largely due to the modestly sized overhead doors with mitered corners, the extra line of trim and cupolas. But make no mistake, even though it will hold lots of “big boy toys” in the heated shop, the shed end holds volumes of big farm machinery, thanks to a 36' split slider on the (less visible) end.



puts its best face forward

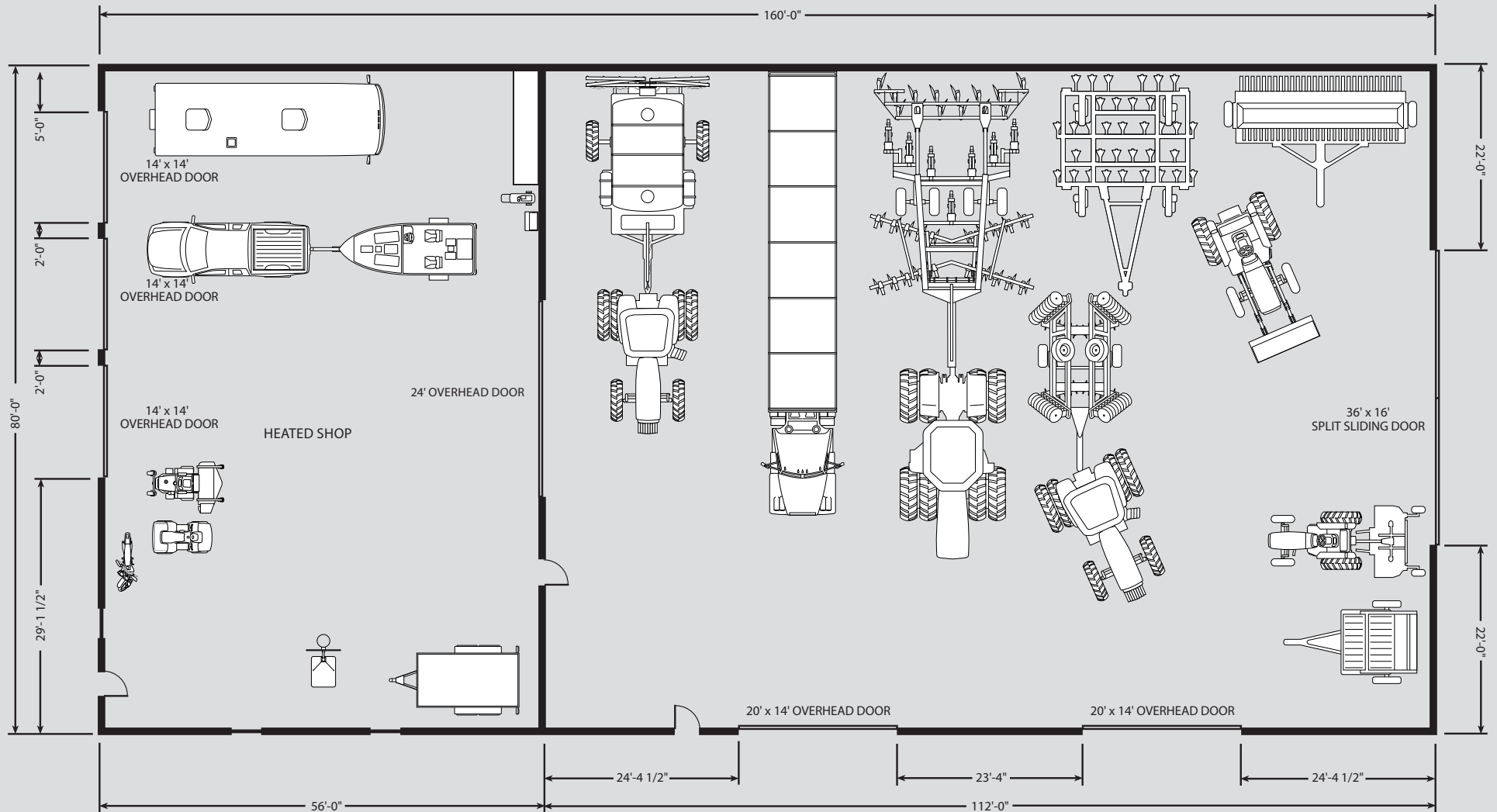



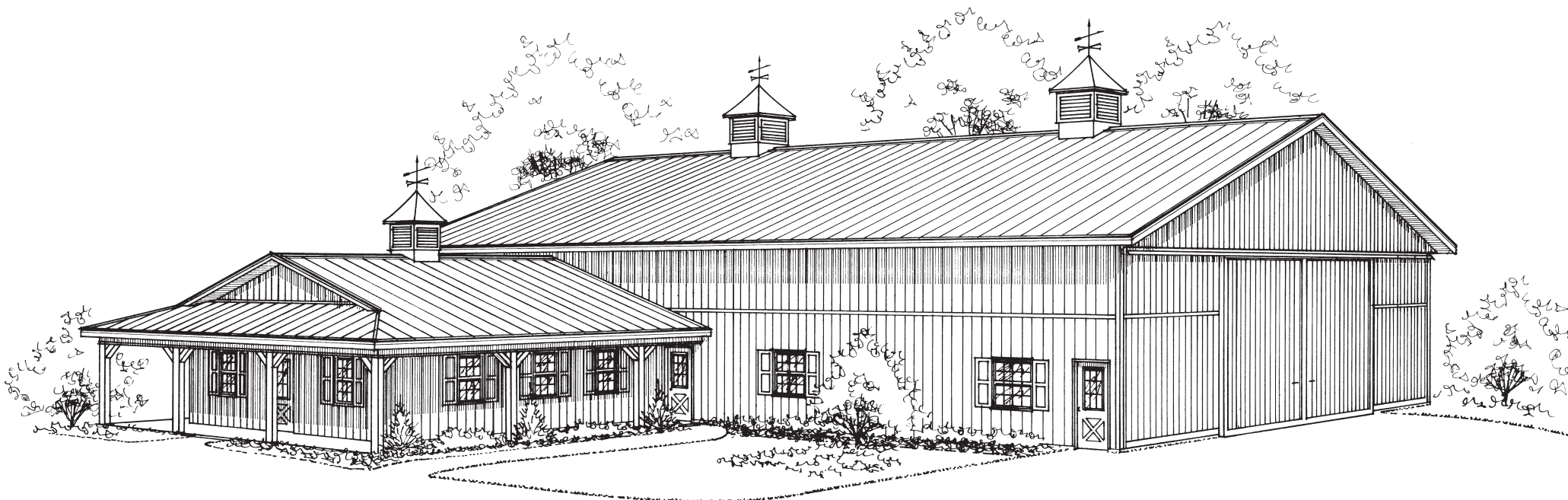

# Double Duty



IF FARMING ISN'T YOUR ONLY BUSINESS, consider accommodating both with one building. This layout is designed for a farmer who also has a thriving crop insurance business - but you could configure the office portion to work for a wide variety of uses. Whatever your sideline, you and your family will appreciate the wraparound porch with cedar posts. It really sets off the office space. The cold storage portion is excellent secondary storage for large farmers, or as the primary storage area for smaller operators.





if farming isn't your only business

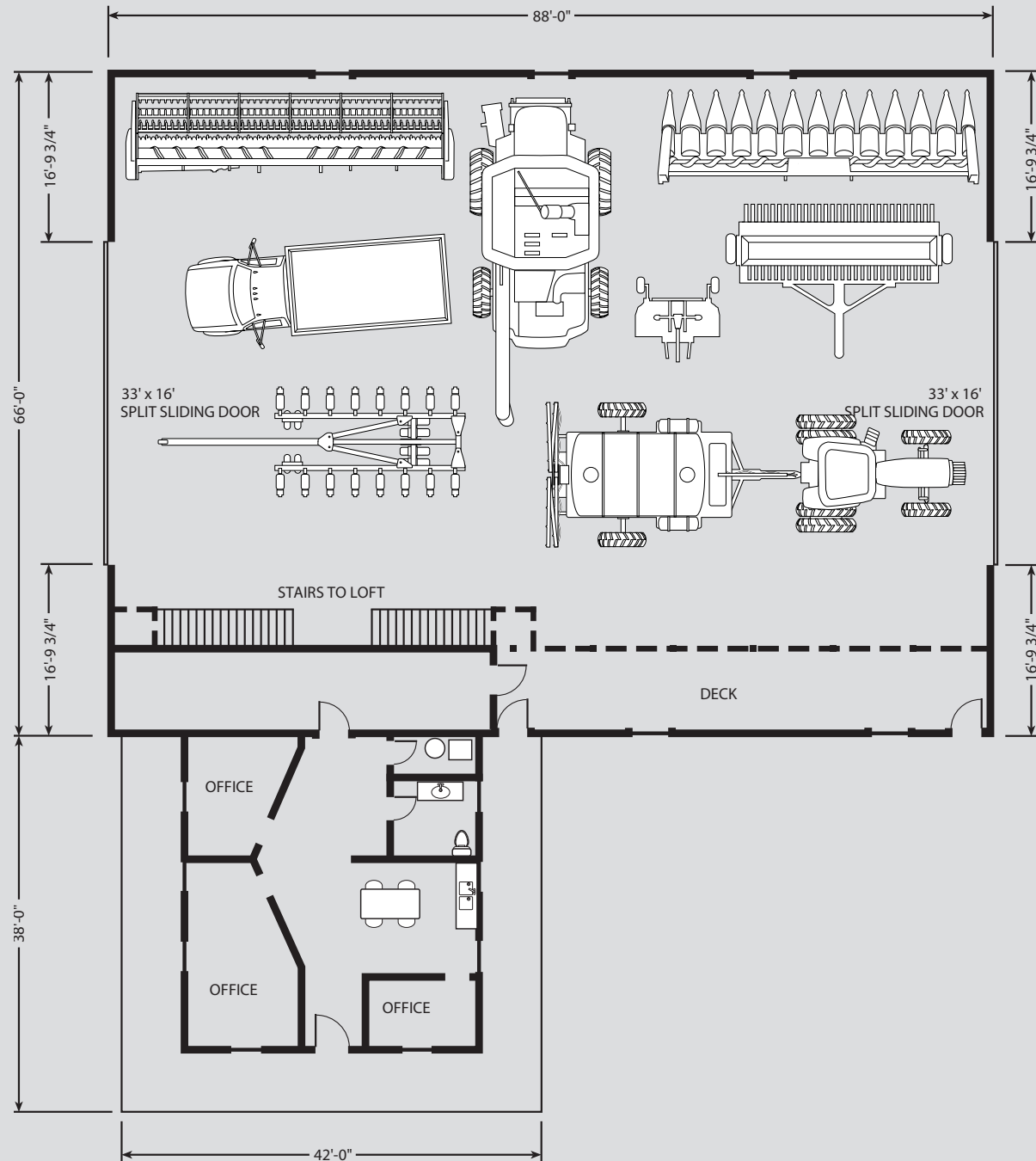

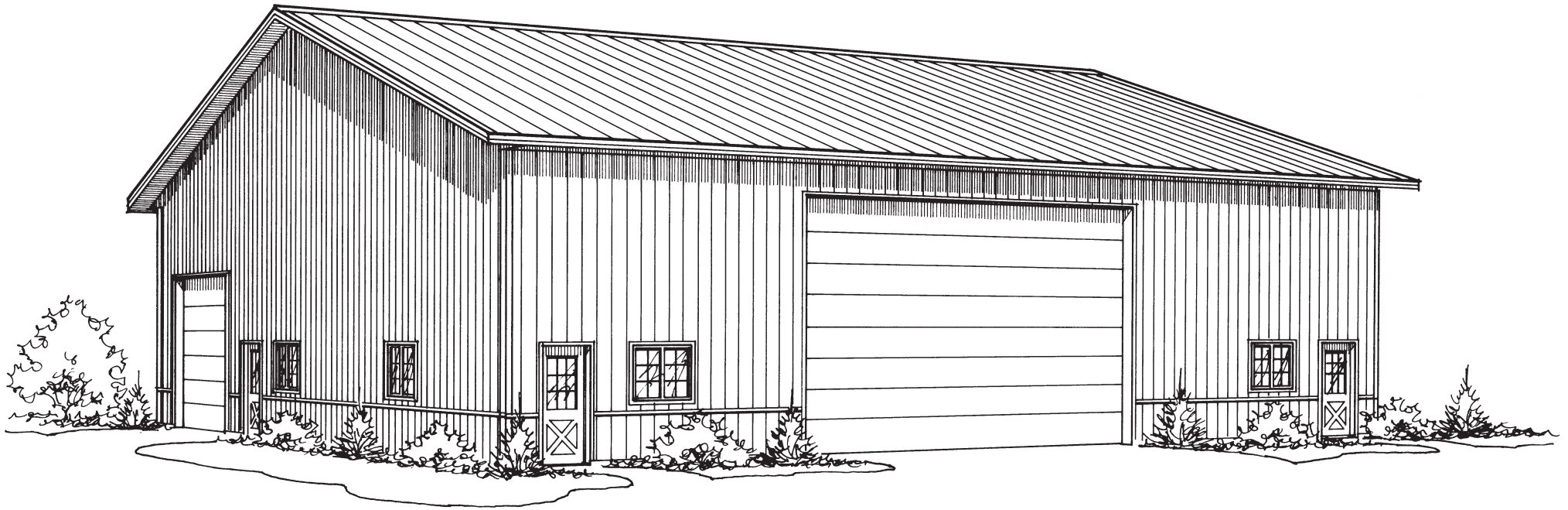

# Silver Squire

## THIS SHOP WILL MAKE YOU A DEDICATED ADMIRER

As workshops go, it's a straightforward design, but done exceptionally well with good proportions, nice aesthetics and easy accessibility. The main door welcomes large equipment into the warm, dry, comfortable work environment. Inside, a large deck helps keep things organized and provides a cozy spot for your workbench below. The back of the building is designed to also accommodate your hobbies, whether they be boating, camping or other outdoor recreational pursuits.





a dedicated shop you'll admire

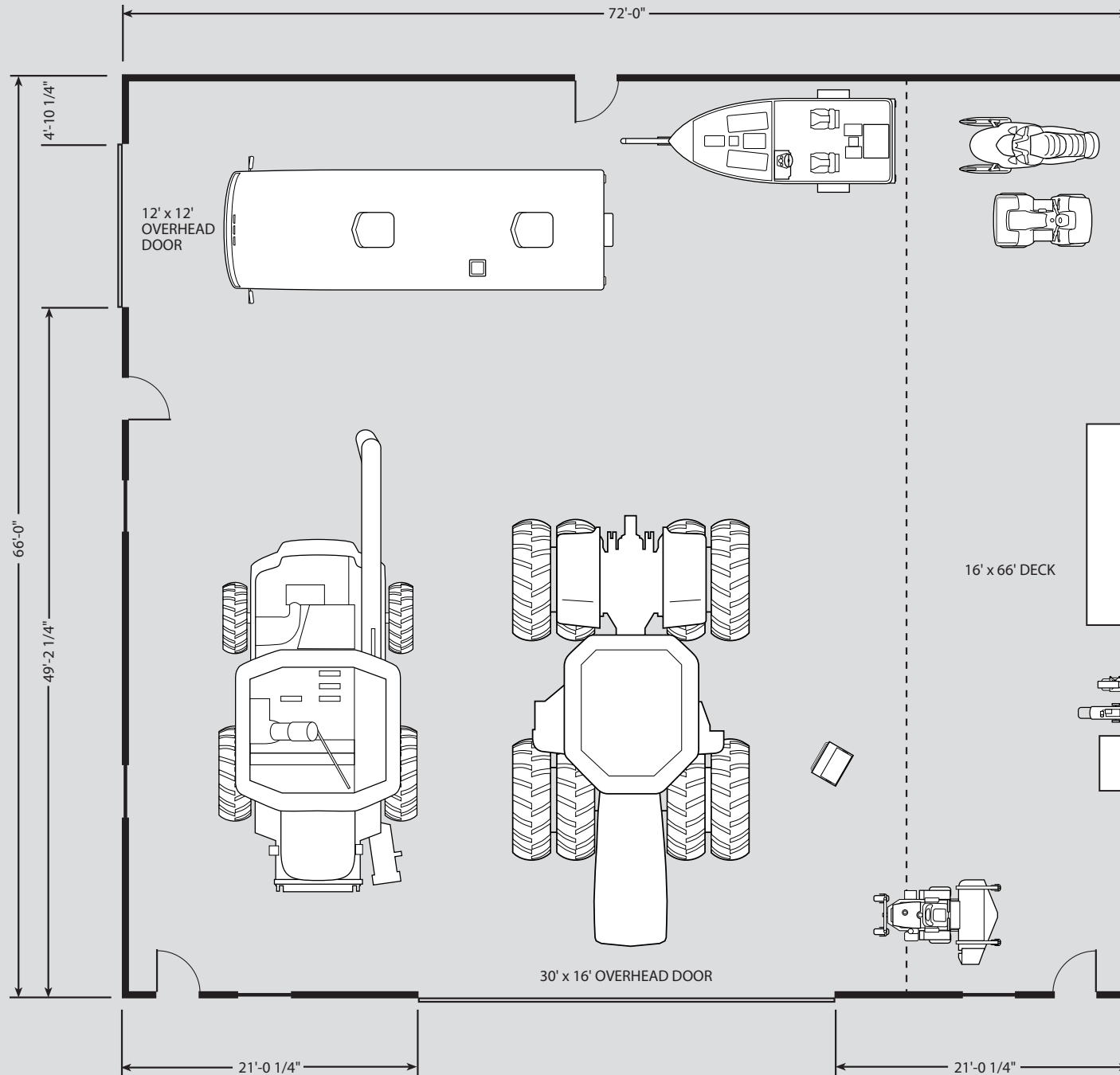

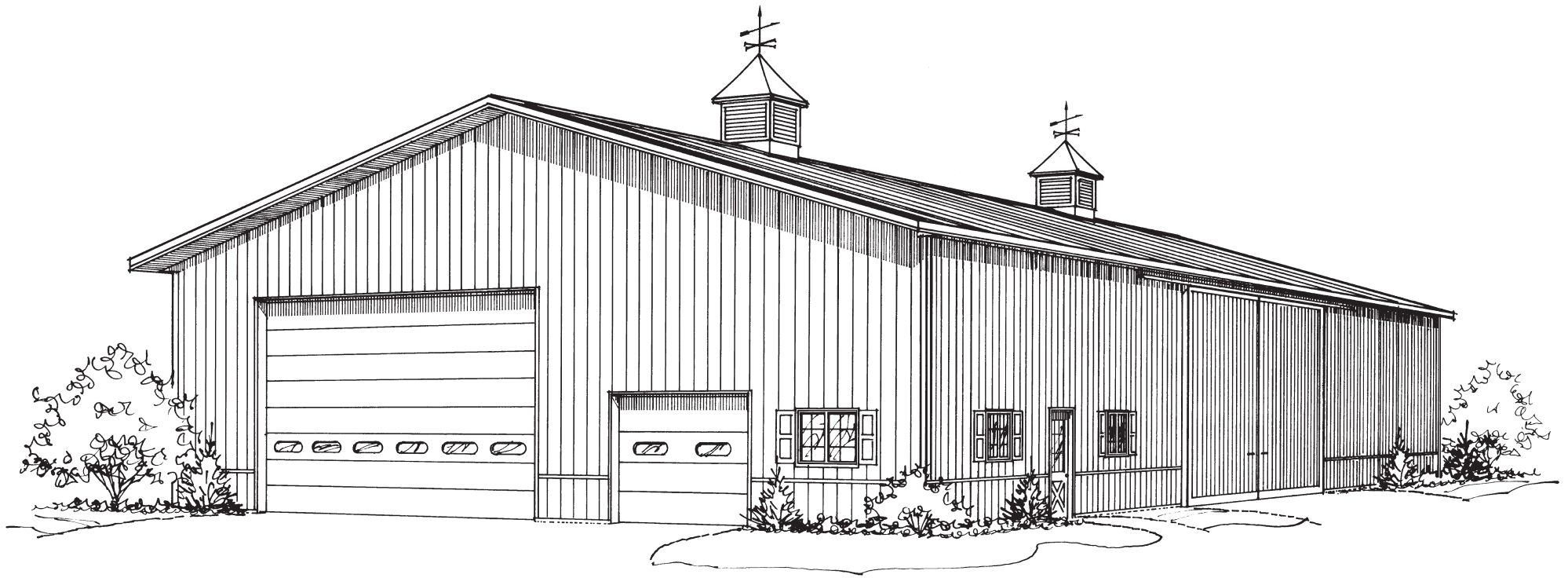

# Freeholder Favorite

## SHOP MEETS GARAGE MEETS SHED

Often farm buildings get used for multiple things. And when you've got all that clear-span flexible space, why not? Every guy deserves a warm place to park his pickup and store his tools now that his wife and kids have taken over the house garage. Thus, the small overhead door. Next to it, a large overhead door provides entrance to the business side of the shop. In back, a moderate size tool shed provides storage for farm equipment.





shop meets garage meets shed

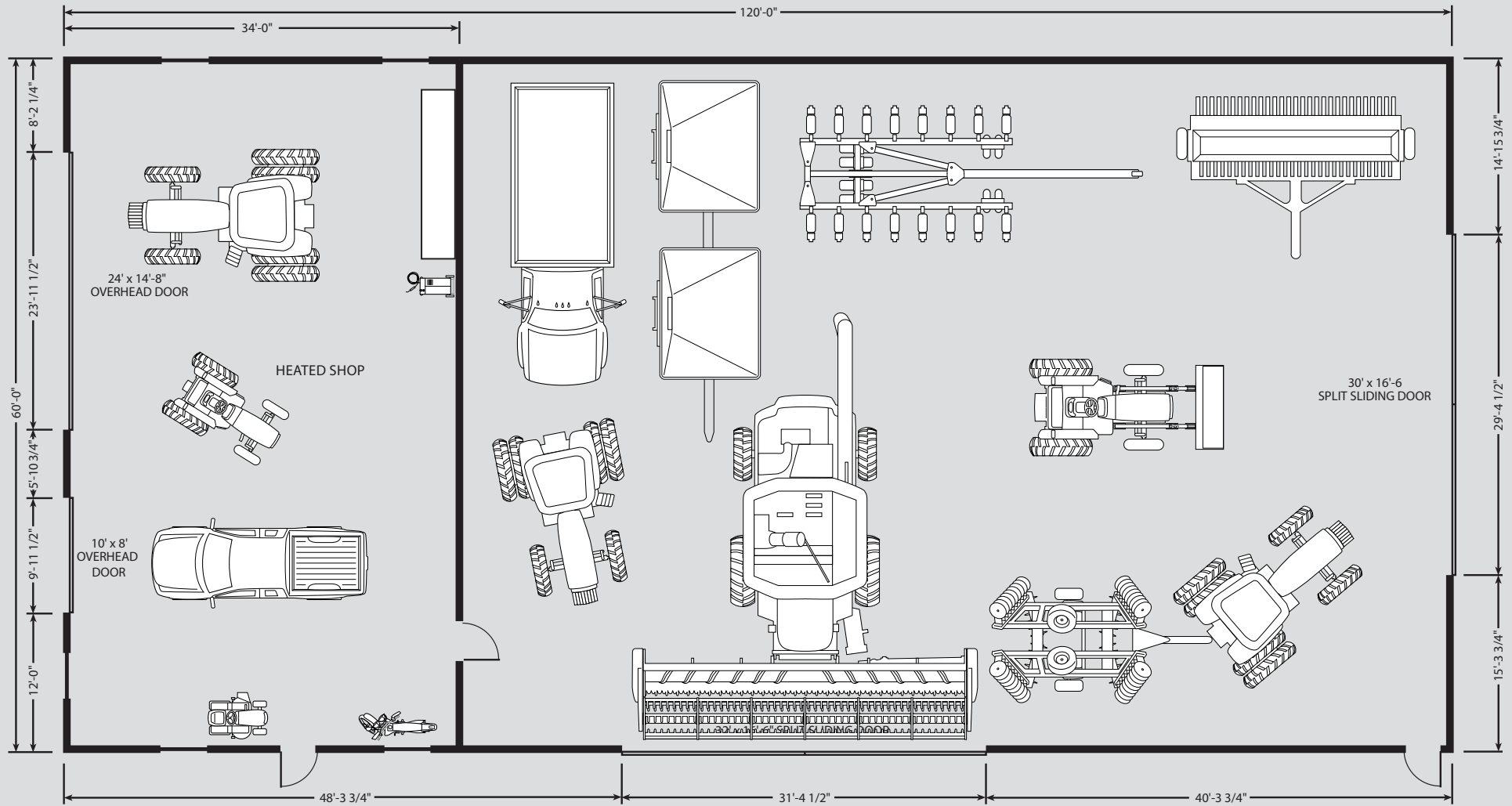

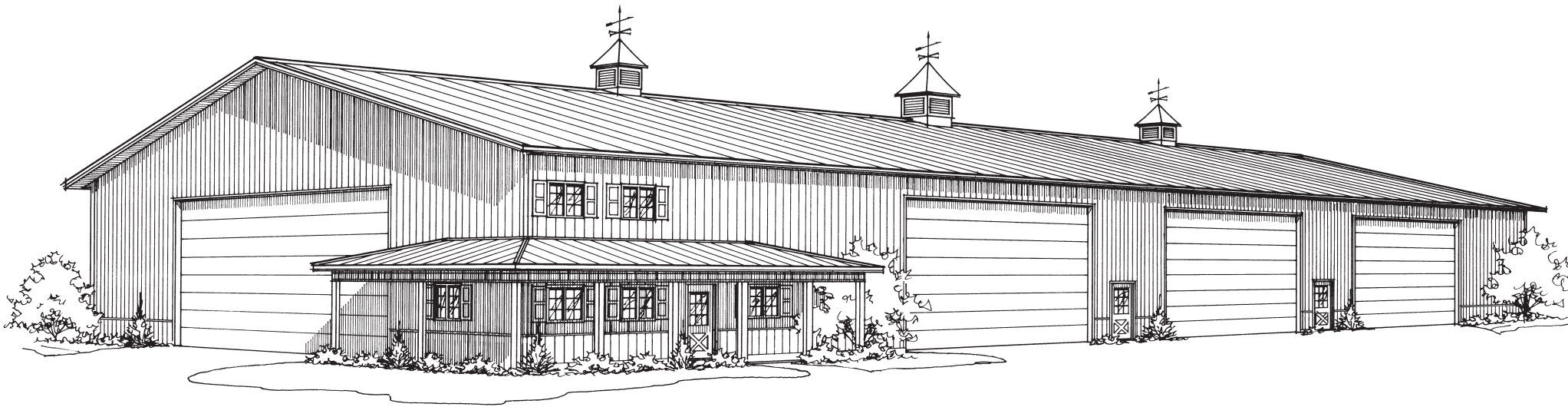

# The Homestead



## GET IN AND GET OUT - QUICKLY

If efficiency is your priority, then you'll appreciate what lots of space plus four large doors can do. Whether you are coming or going, equipment is able to freely flow through. Time spent moving things around is practically eliminated. A small apartment in the front corner of the building provides a place for hired hands – or you – to stay overnight during the press of planting or harvest. This is an excellent feature if you live away from your farm. You can wake up and go right to the fields!





get in and out - quickly

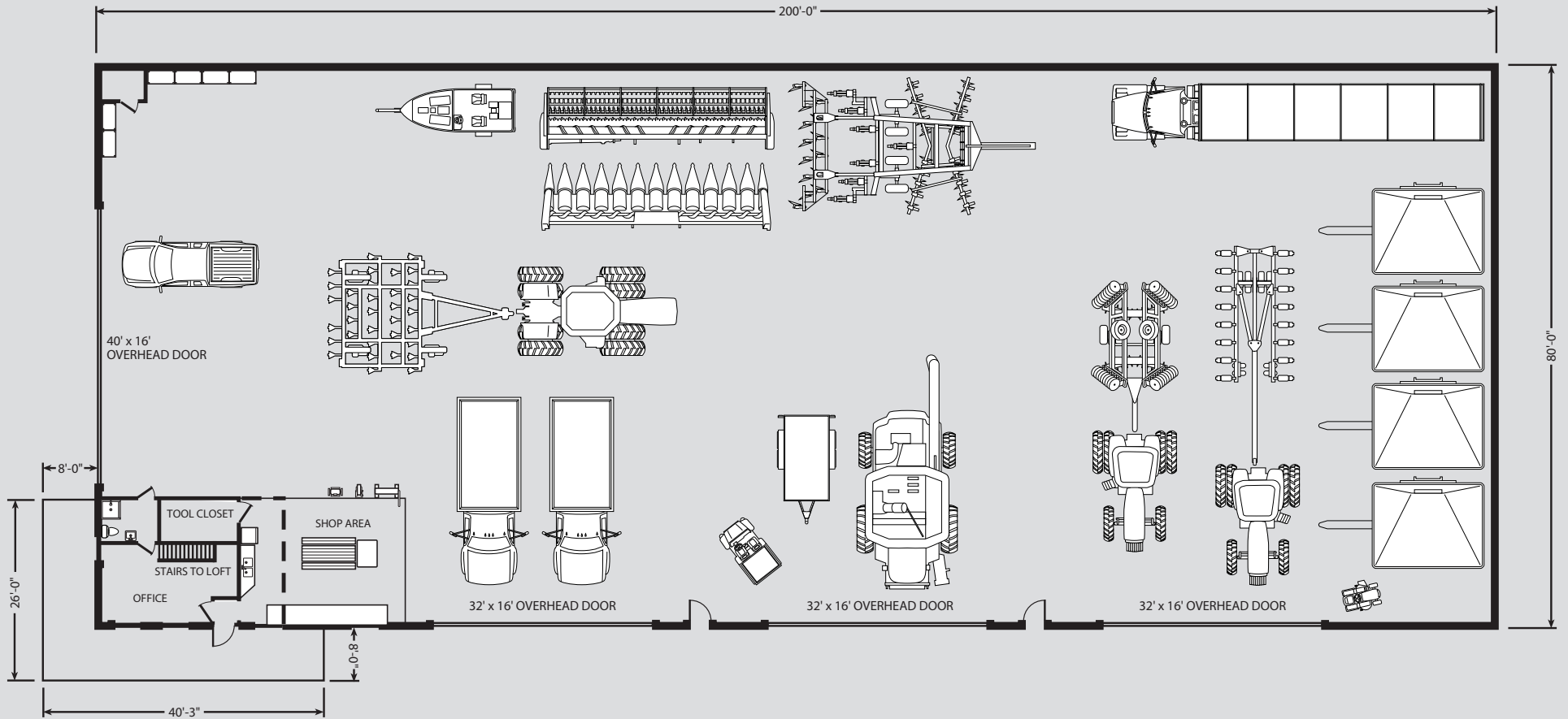

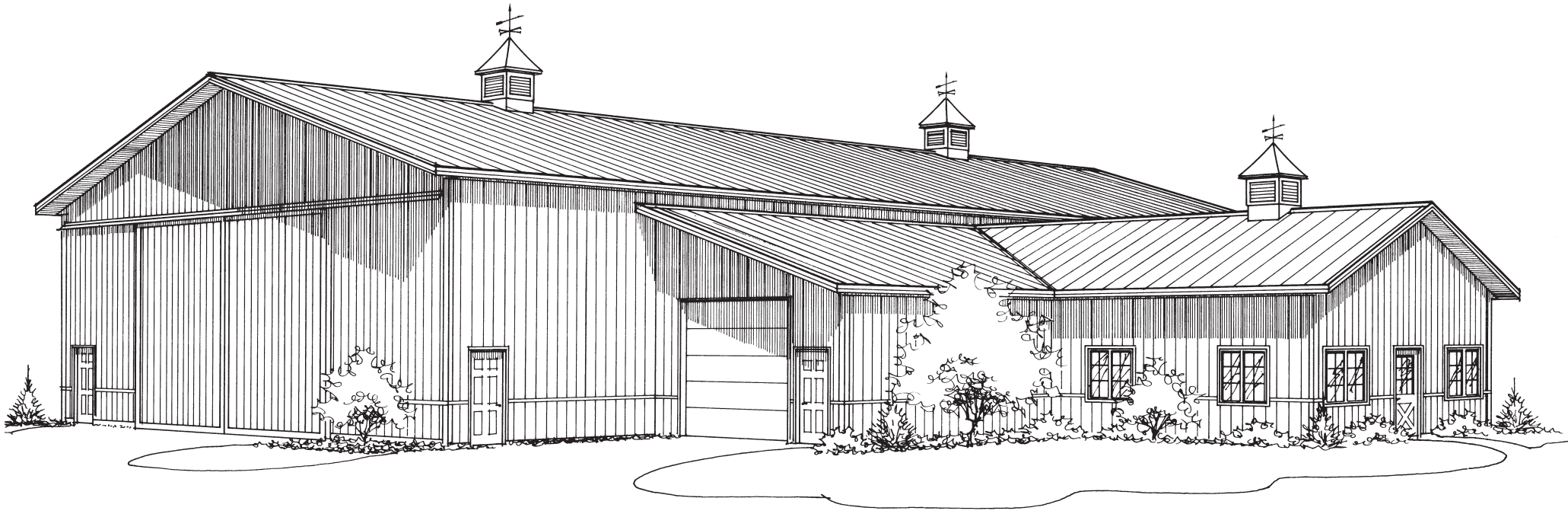

# The HQ

## WHERE THE BIG DECISIONS ARE MADE

As farming operations get larger, so too does the need for a centralized office, or headquarters. This building provides the necessary office space for planning, doing book work, marketing grain, having meetings — whatever you need. You'll also appreciate the full kitchen for preparing field meals. Behind the office is a pass-through shop, designed primarily for vehicle and small equipment maintenance.







where the big decisions are made

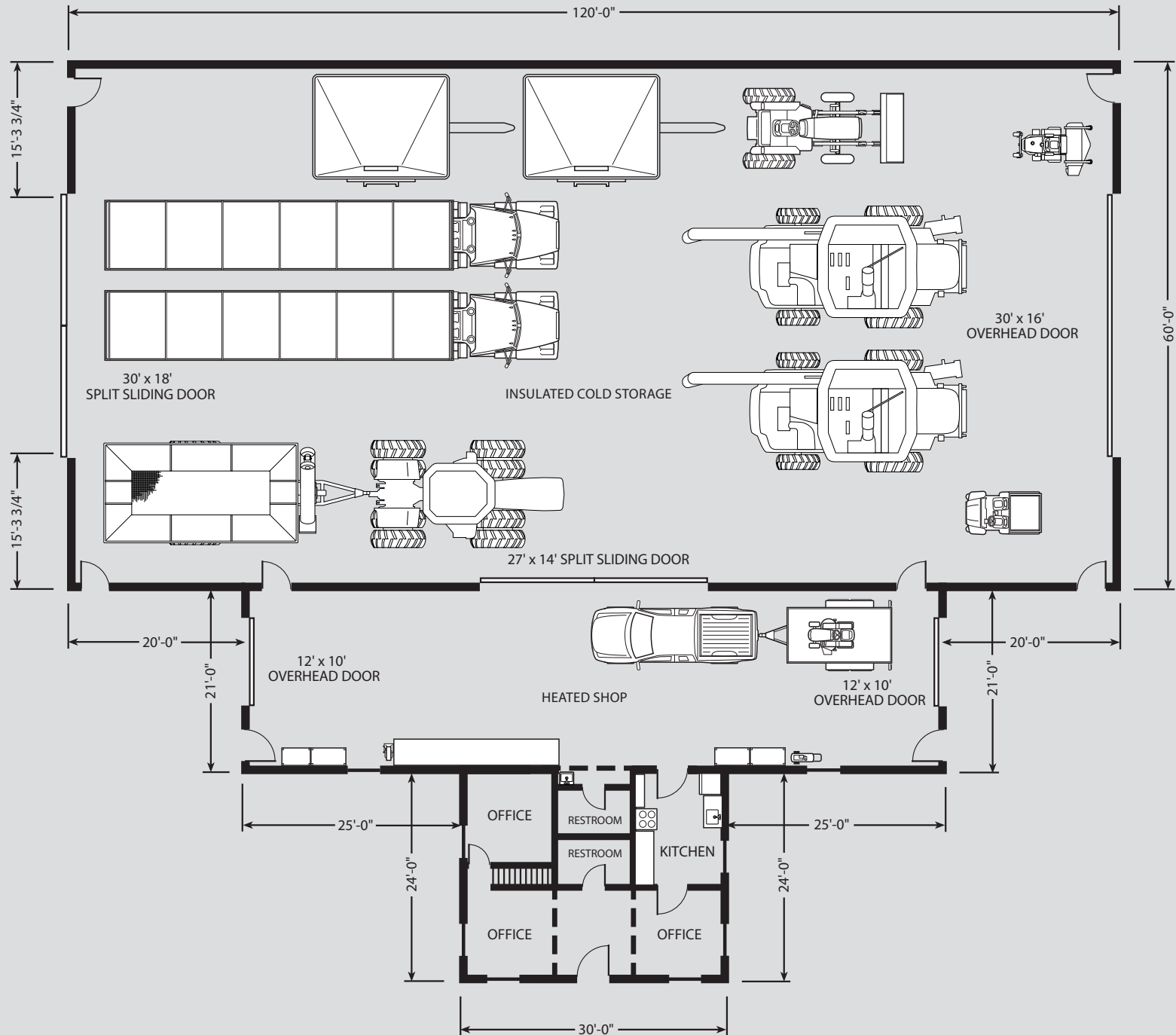

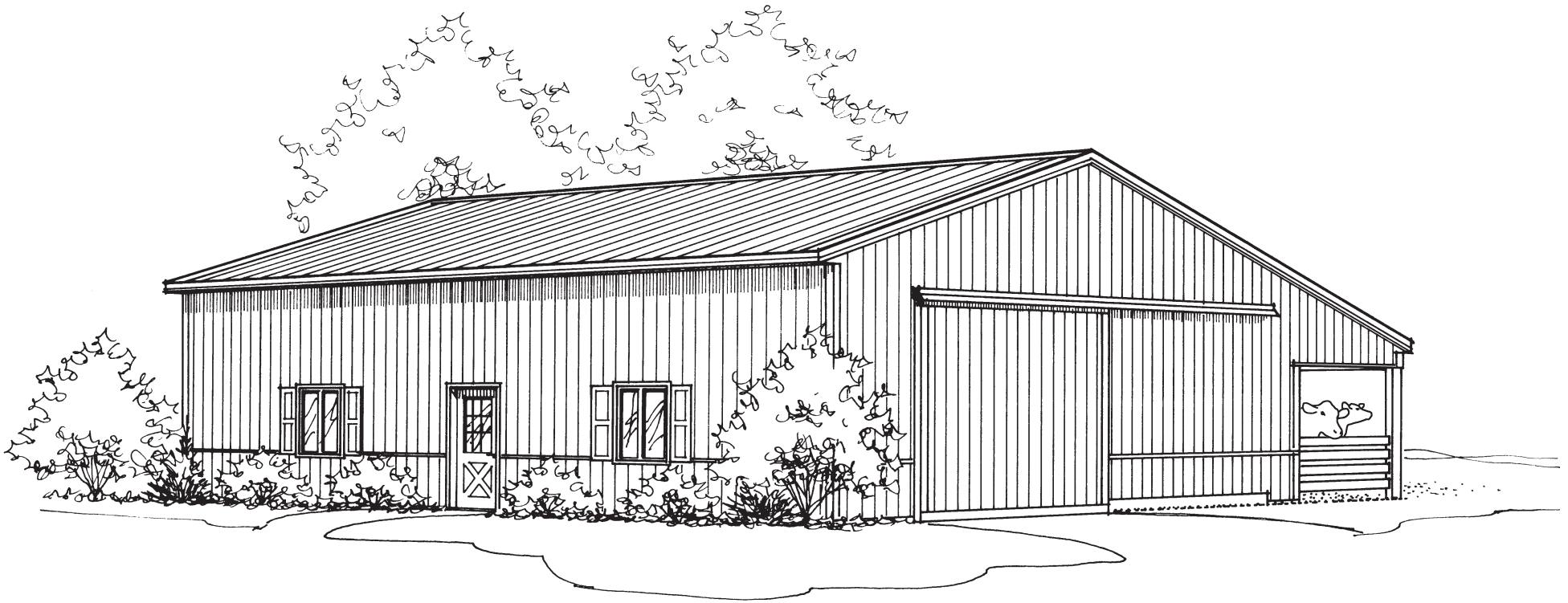

# Junior Stockman

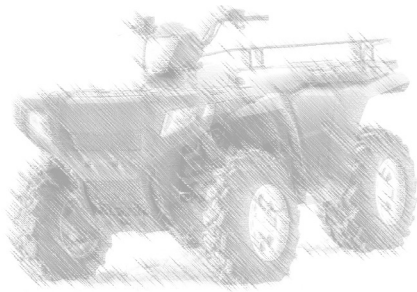

## SERIOUS ABOUT 4-H?

This building might just make the whole family happy. Accommodate numerous pigs, goats, lamas or cows along with all their necessary paraphernalia, and you'll still have plenty of room left over for a tractor or two. (Seems like your main tool shed is always full, isn't it?) Best of all, this building is attractive enough that your wife won't mind looking at it.





keep 4-H animals and extra equipment

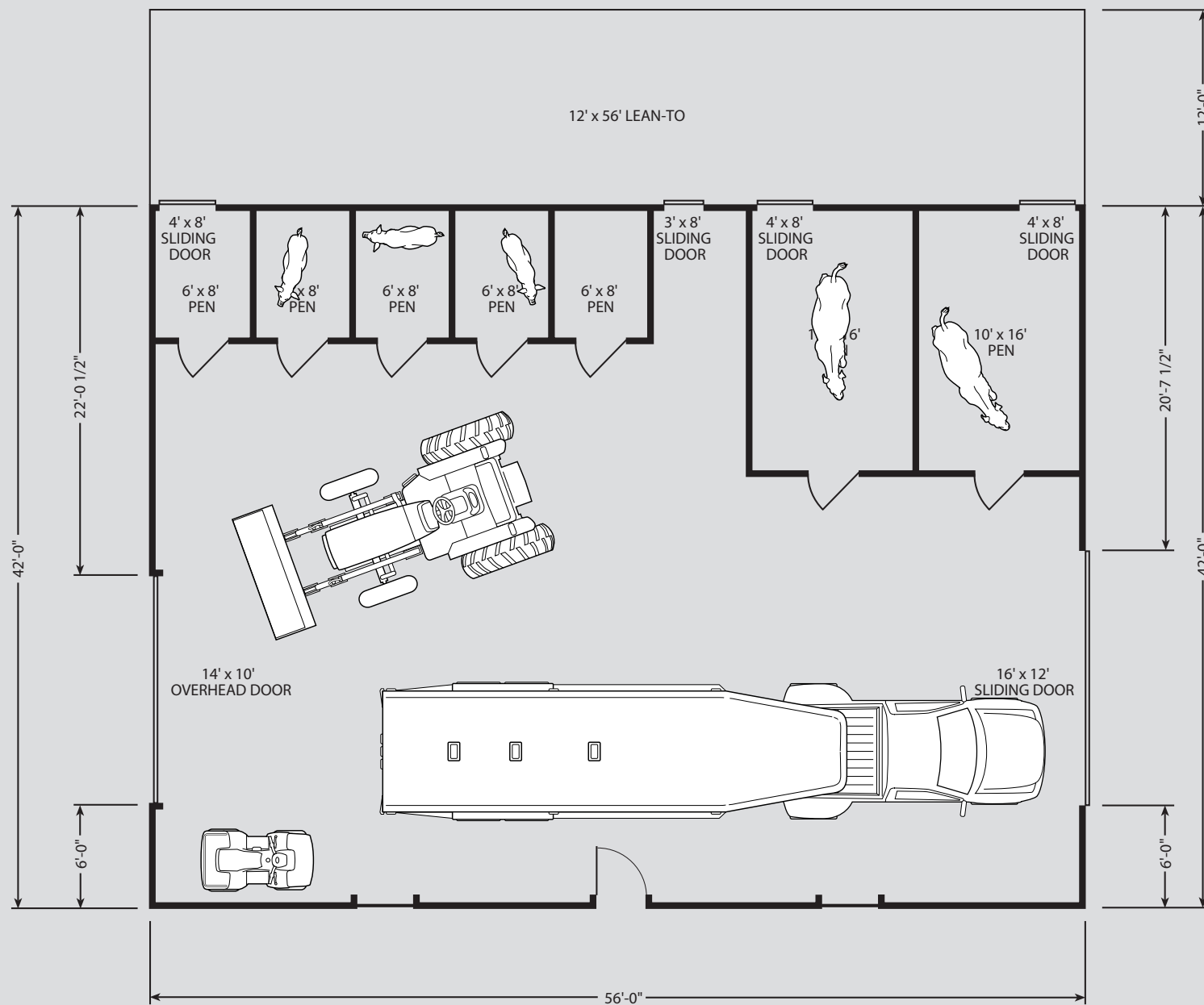

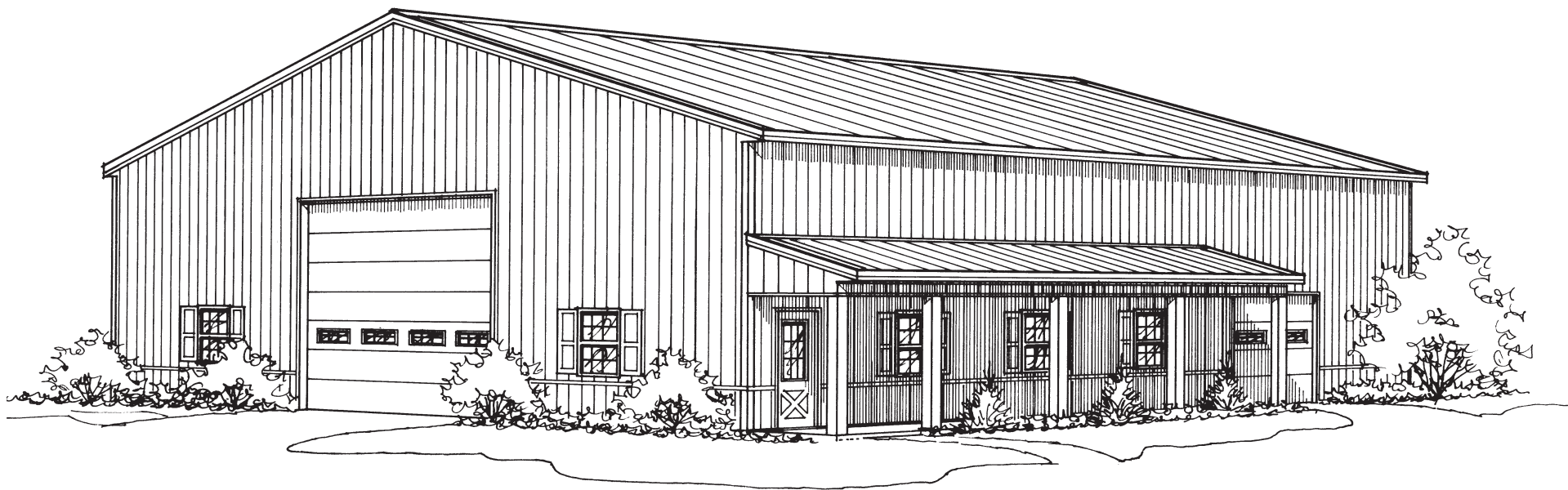

# Yeoman Ltd.



## PUT THIS NEXT TO YOUR NEW HOUSE

If you've moved off the primary farmstead (where you store most of your equipment) but still have the occasional need for some horsepower around home, look no further. This shed is large enough to handle the "overflow" from your big tool shed and also provides space for the family's stuff and your work shop. A large porch dresses up the exterior and creates a pleasant gathering space.





put this next to your new house

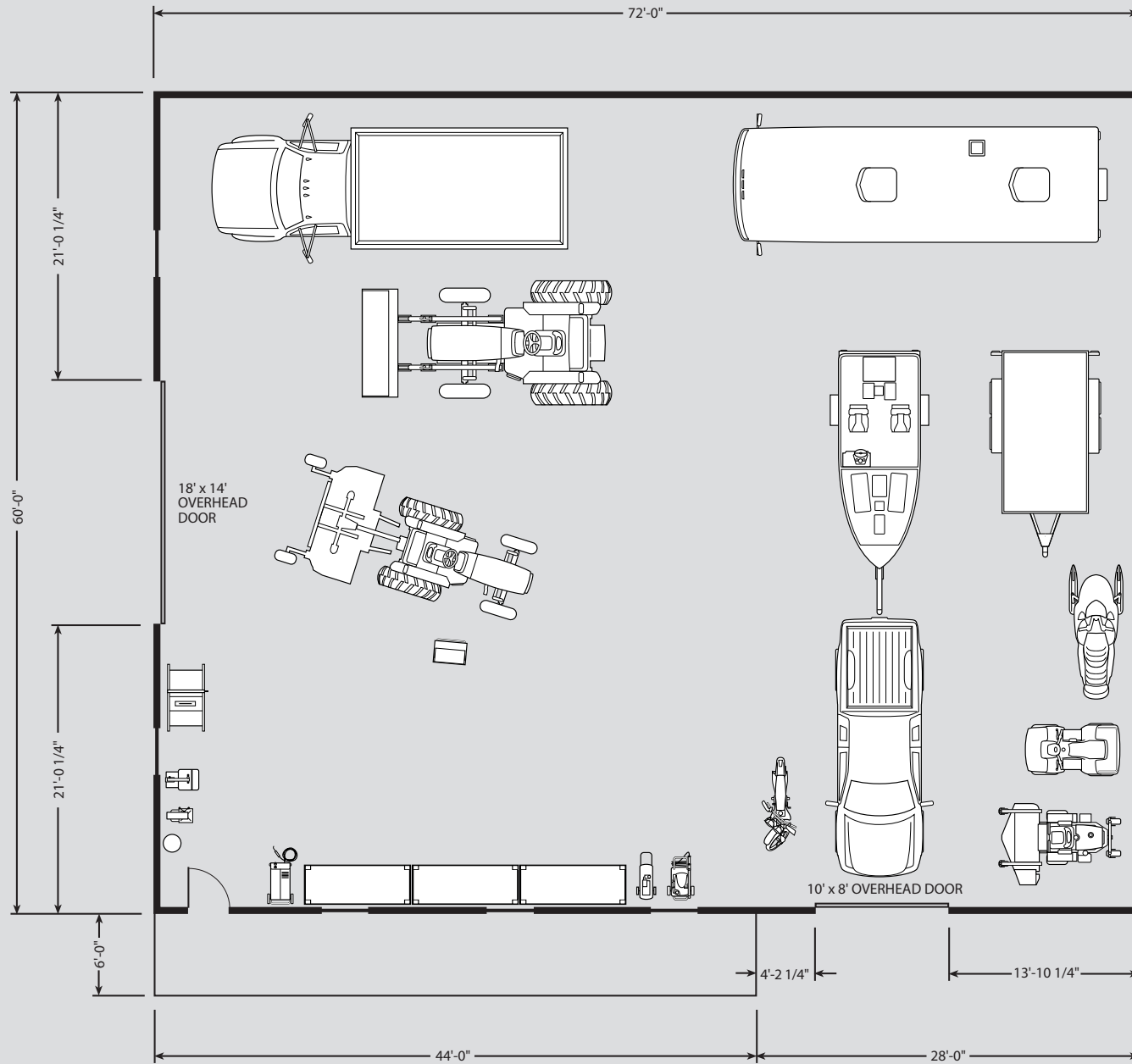

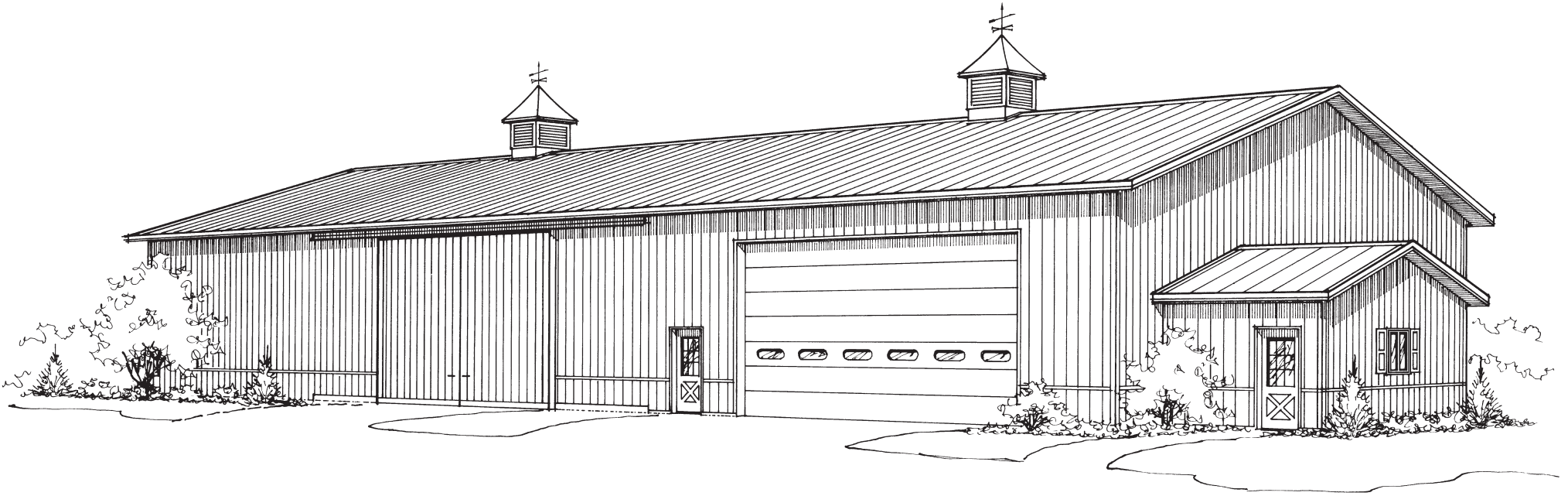

# Steward's Shed

WHEN YOU WANT TO GET AWAY – BUT STILL STAY CLOSE  
More and more farm buildings include offices. Many farmers just build them into a corner of the shop. Others, take this approach. The advantage of going this way is you are able to completely get “away” from the noise and dust of the shop and shed. That’s important if you need to concentrate on weighty matters. It also makes the exterior of the building more visually interesting.



when you want to get away – and stay close

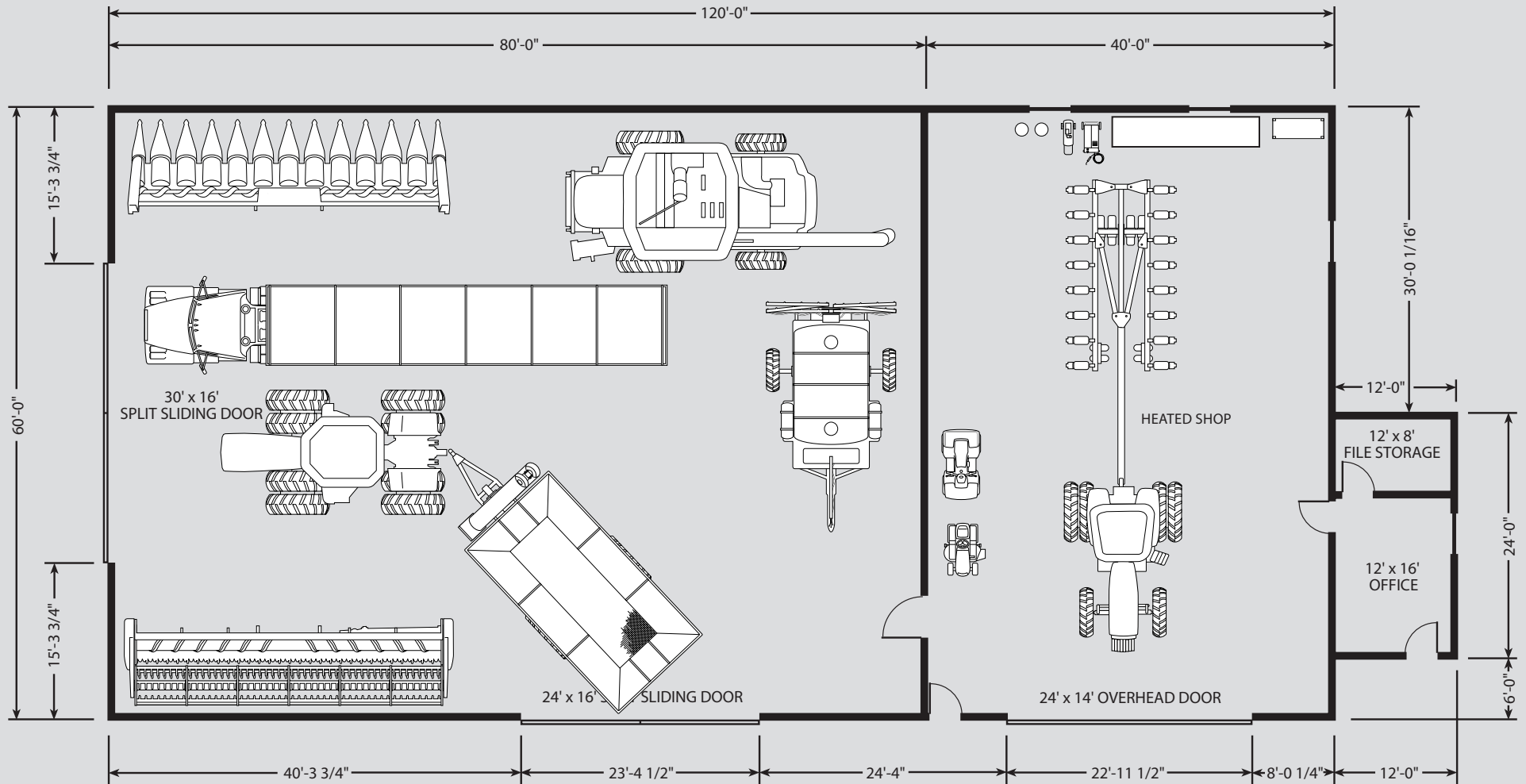



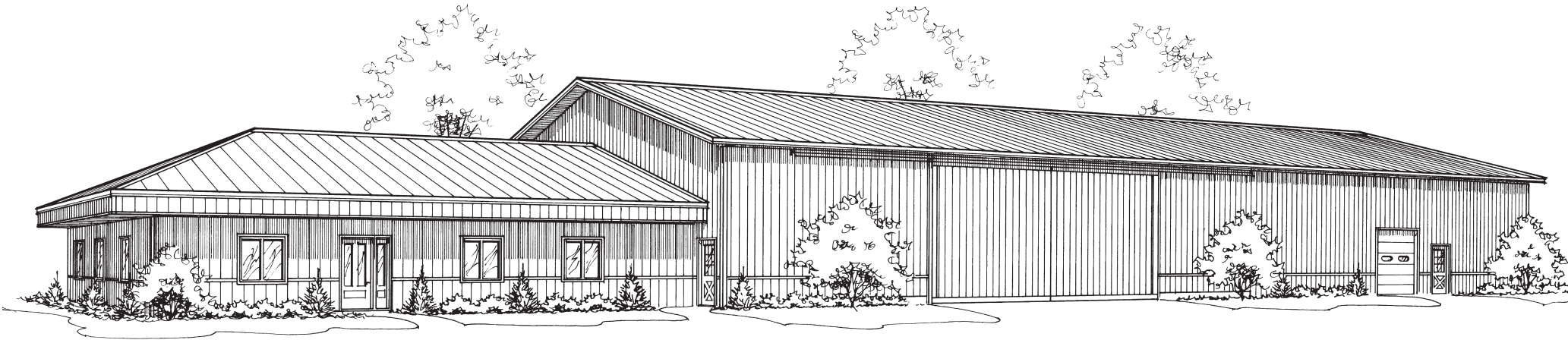

# Business Center



## COMMERCIAL, MEET AGRICULTURAL

This is a hybrid building that combines a large storage shed with a large commercial office, used in this case for the bustling seed dealership of a multi-family farm. The hip roof and boxed overhangs give the office area its “downtown” air. Adjoining the office is a large tool area/wood shop that also works very well for hosting customer-appreciation dinners. Mmm.... can’t you just smell the pork chops?



commercial, meet agricultural

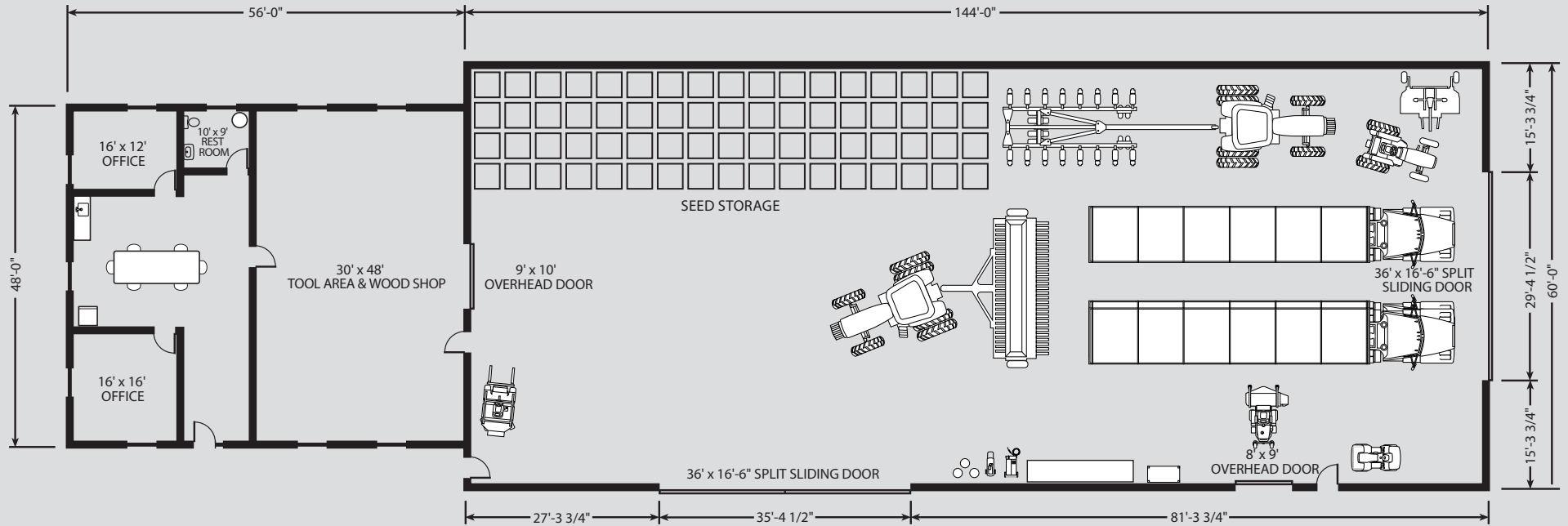

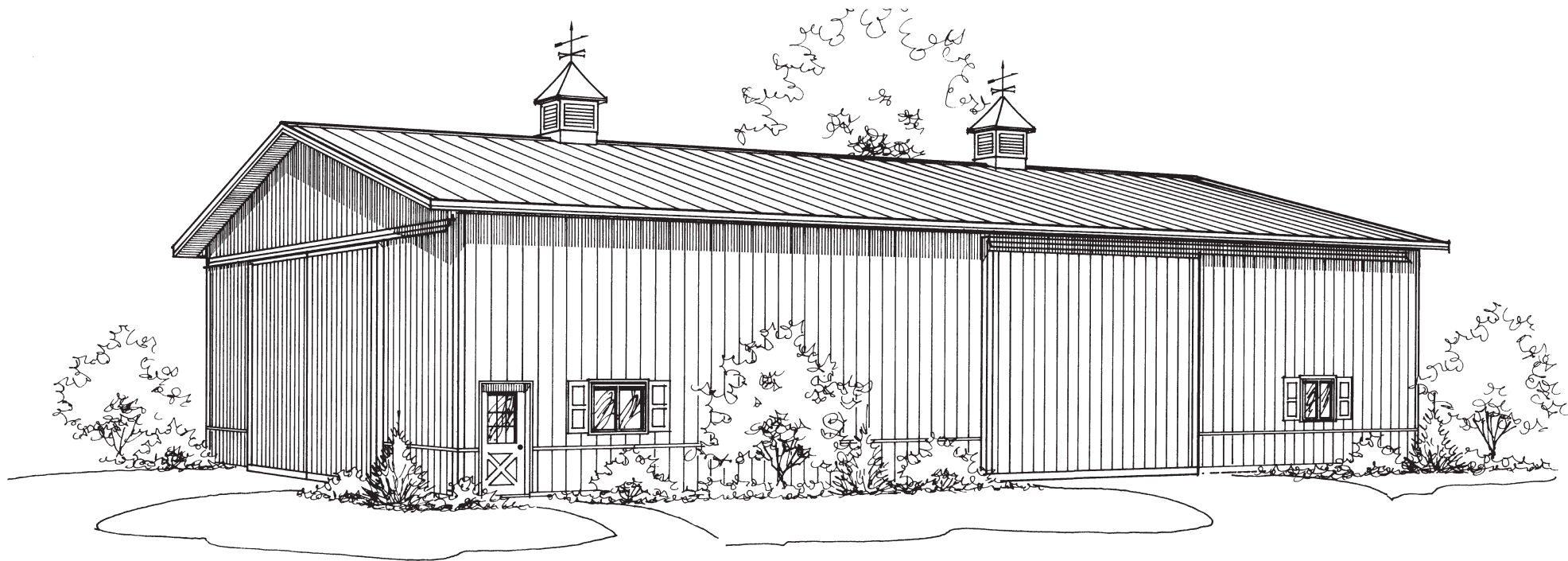

# Country Site

## BASIC, BUT ATTRACTIVE STORAGE

Sometimes a shed is just a shed. But it doesn't have to be plain. Proper placement and sizing of doors, walk door, windows and cupolas makes this feel just right — something you and your neighbors will appreciate. This building provides moderate storage space, generally as an addition to your primary tool shed.







basic, but attractive storage

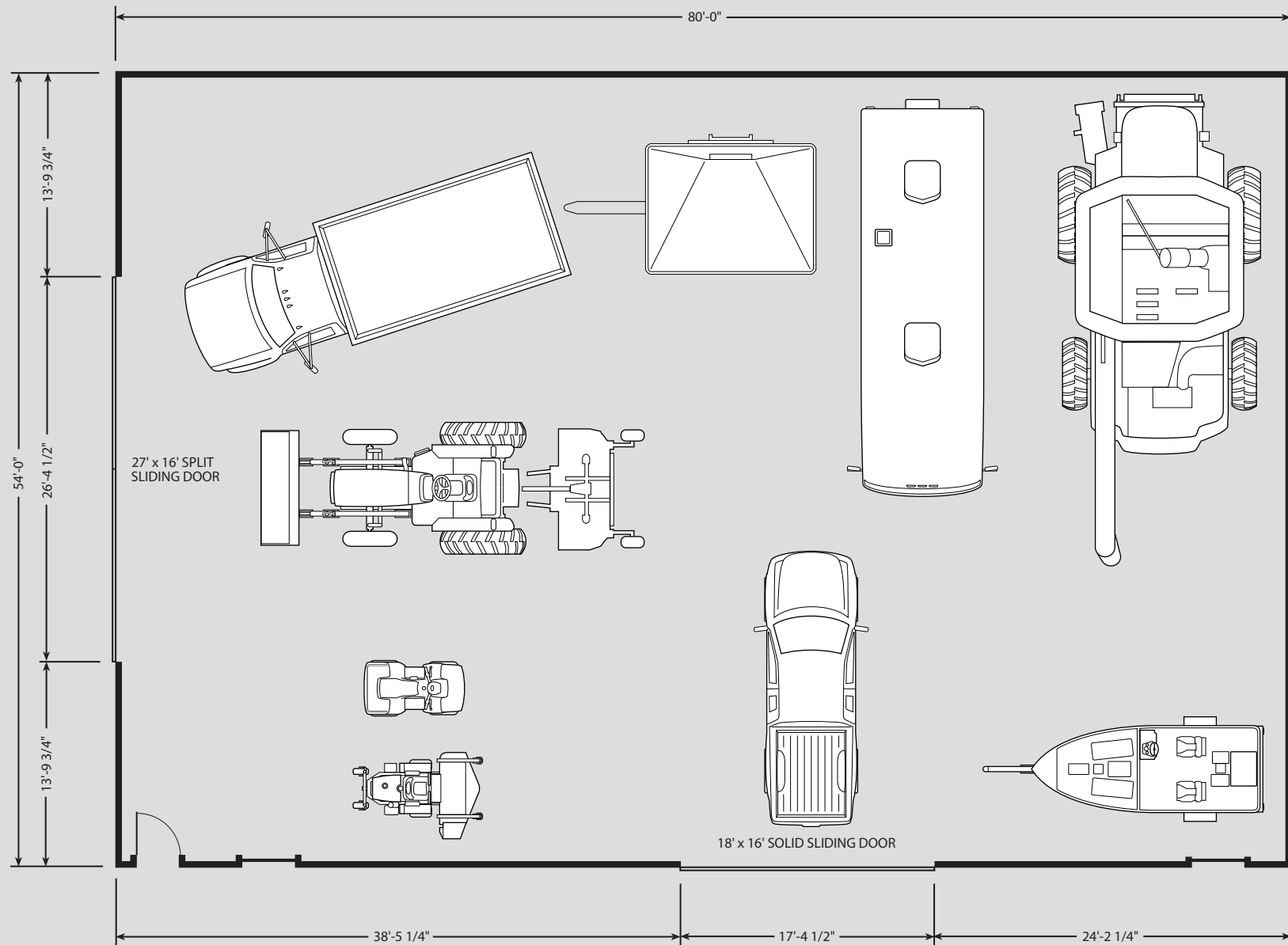

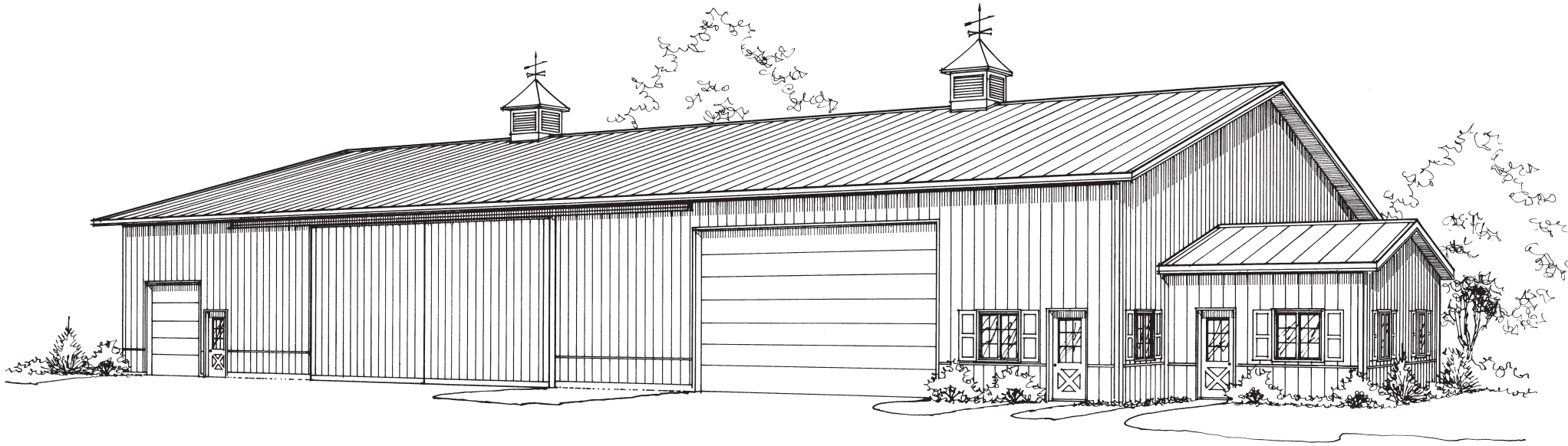

# Top Dealer



FOR THE FARMER WITH A SEED SIDELINE, this plan makes it a breeze to take delivery of seed, store and sort it for customers, thanks—in part—to the loading dock. You'll also appreciate the separate office space, designed to comfortably include one work station plus a conference or lounge area. The shed interior is shown as one wide-open space, but the building is designed to accommodate a future partition wall creating a shop on the east end.



for the farmer with a seed sideline

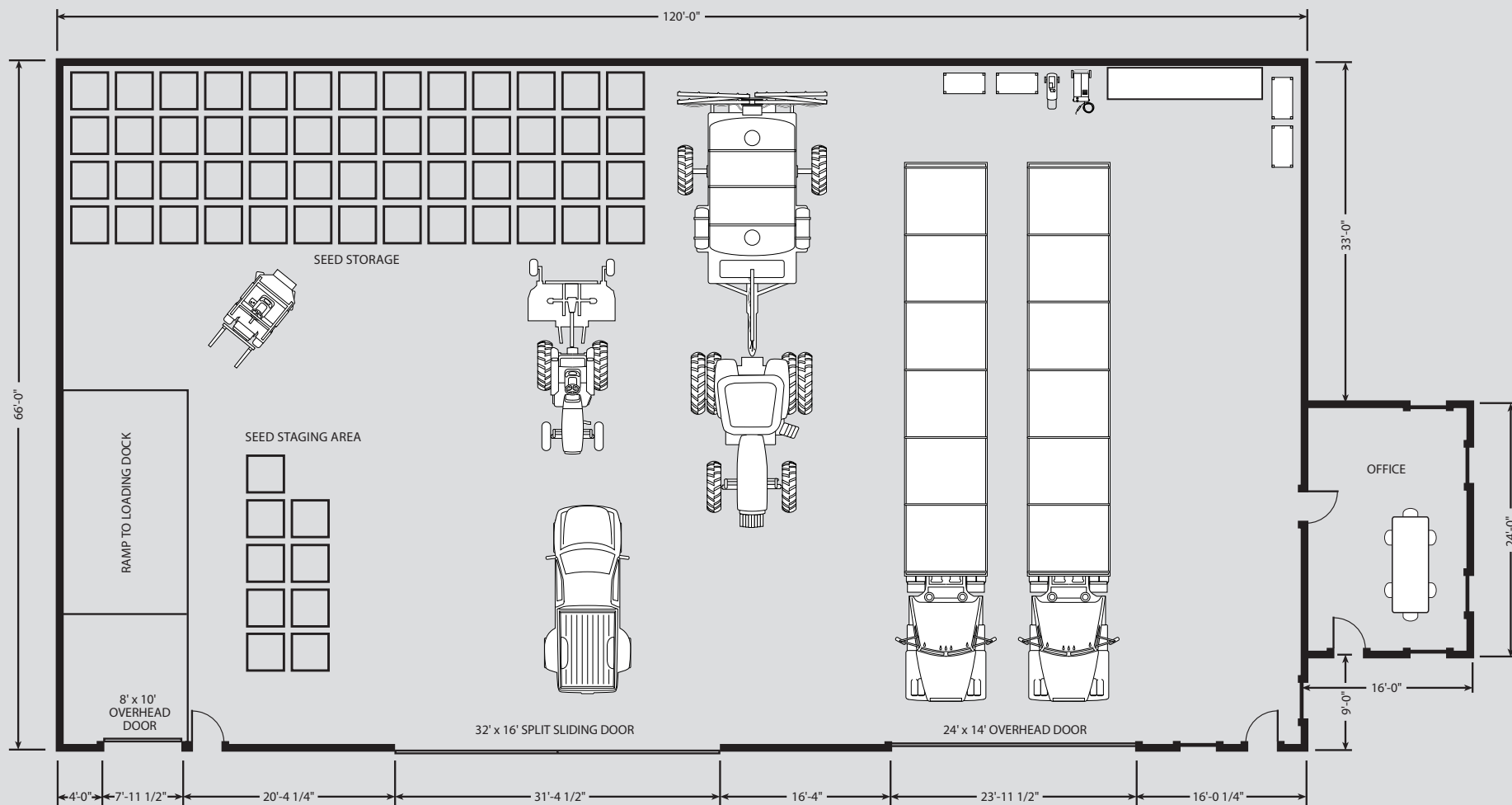



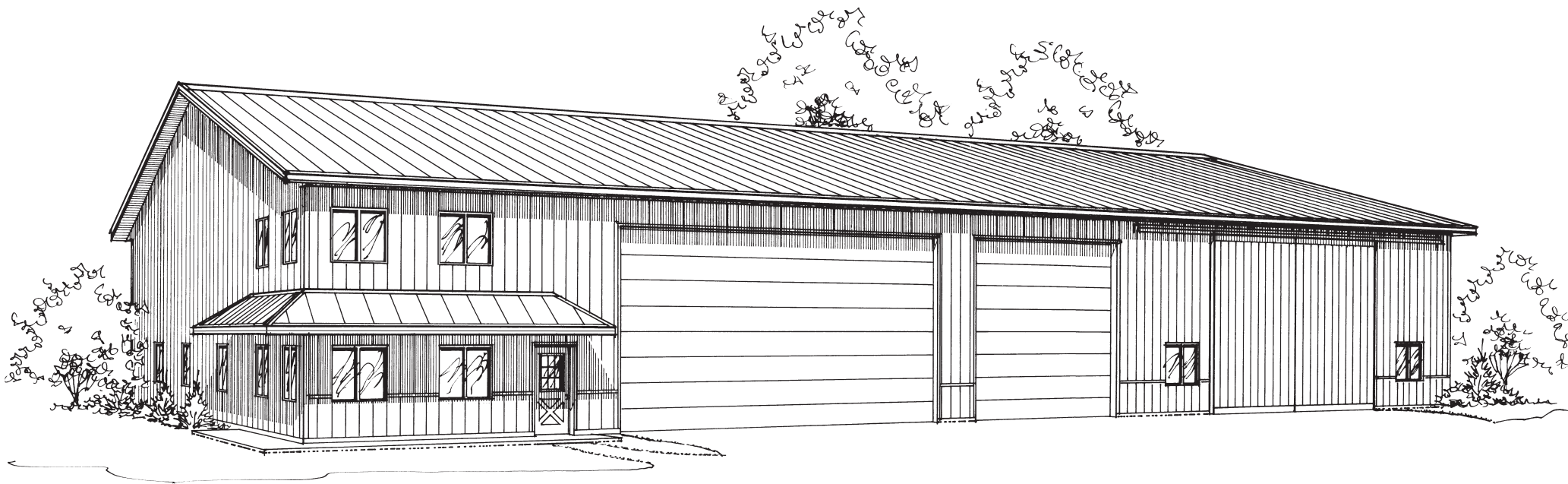

# Legacy Sights

## TWO STORIES OF PURE PRODUCTIVITY

If you need a serious shop plus some additional equipment storage, take a look at this plan. You get 80' x 80' of unfettered space to work on all your equipment in year-round insulated comfort. That area is so large, there is plenty of room to incorporate a spacious farm office and work bench area with a deck above. The deck level is full height and includes windows, so it could be used for much more than parts storage. Perhaps a play room for the kids/grandkids? An apartment for the hired hand? The sky is the limit.



two stories of pure productivity

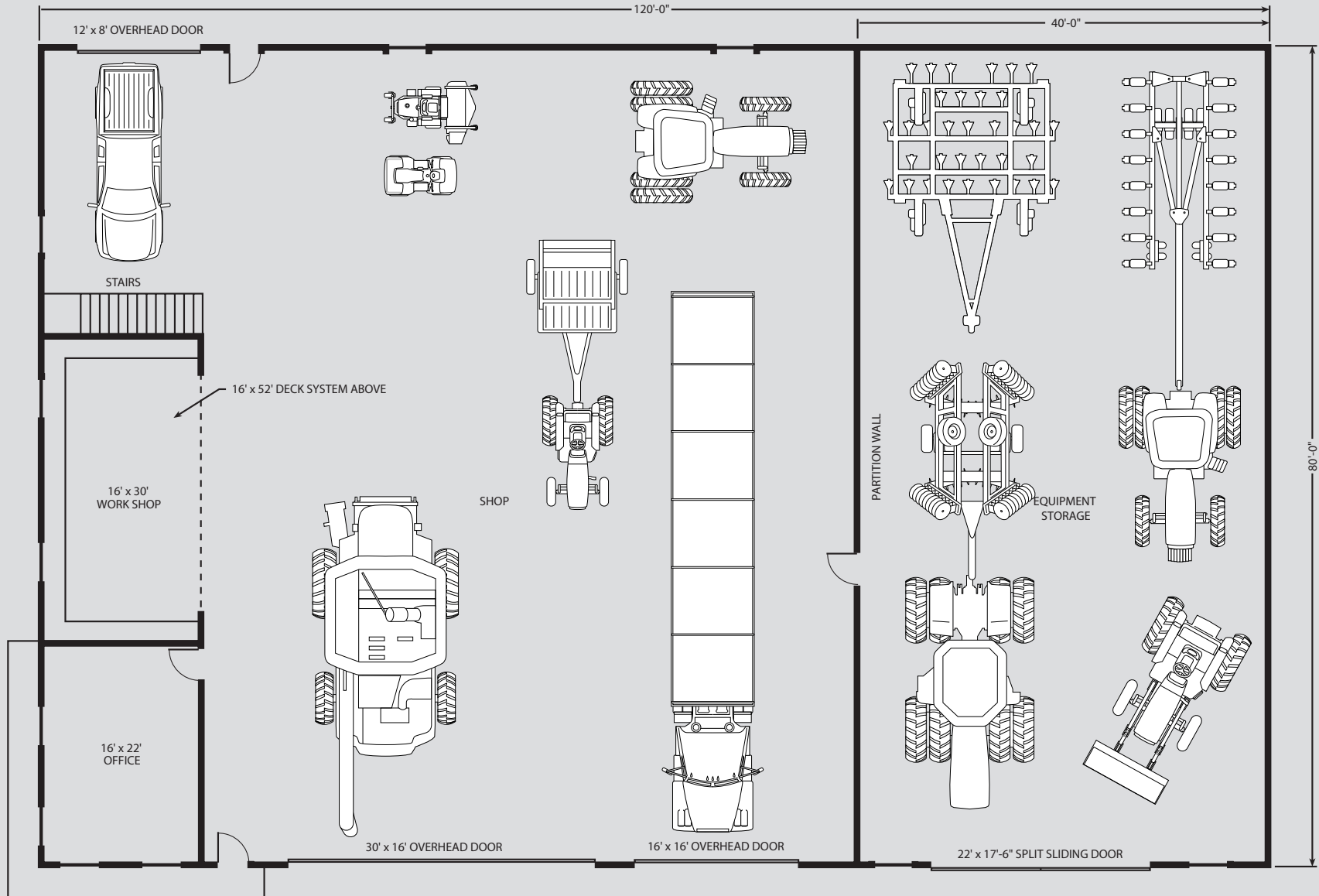

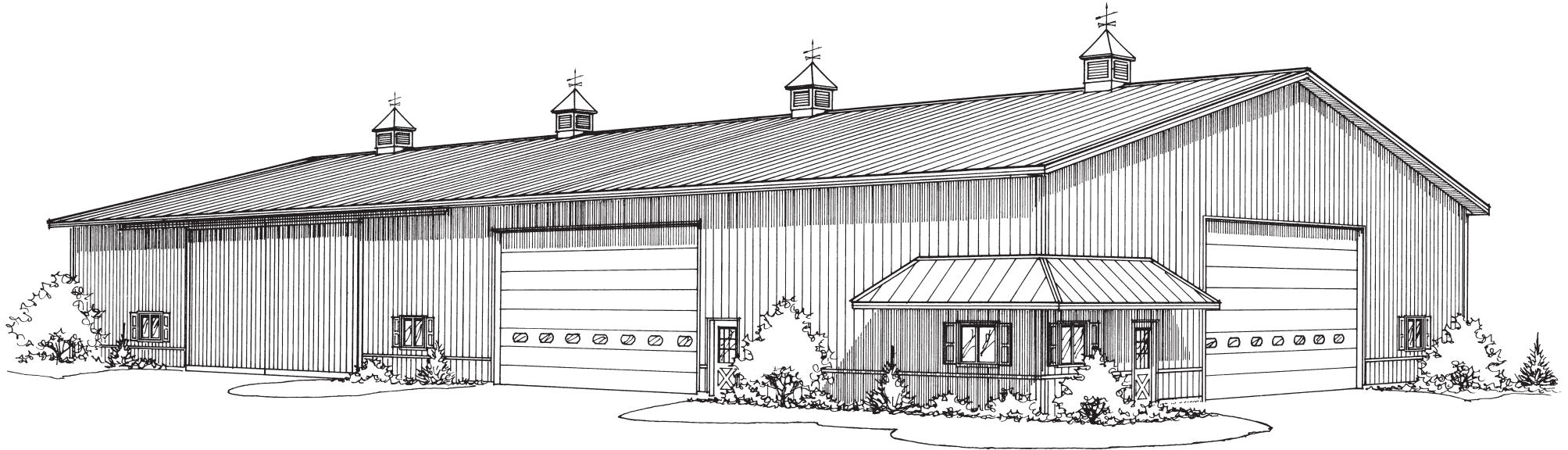

# Heartland Hub

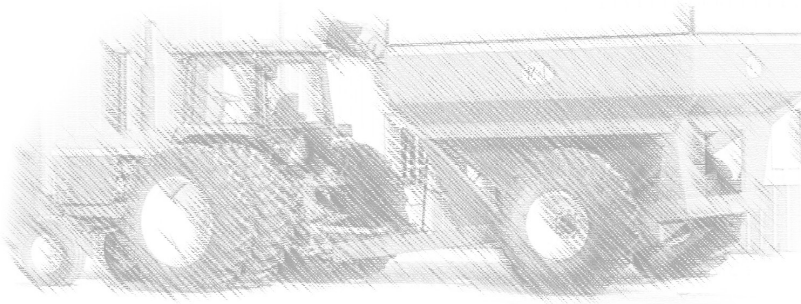

## THE CENTER OF IT ALL

Your operation has expanded, equipment keeps getting larger and your old shed just ain't cutting it anymore. Here's the solution. Establish a new centerpiece of your farm with a generously sized shop attached to a good-sized storage building. You won't believe how much more efficient you can be when you've got space to maneuver equipment inside and room to pull in and service machinery from two sides of the shop.





the center of it all

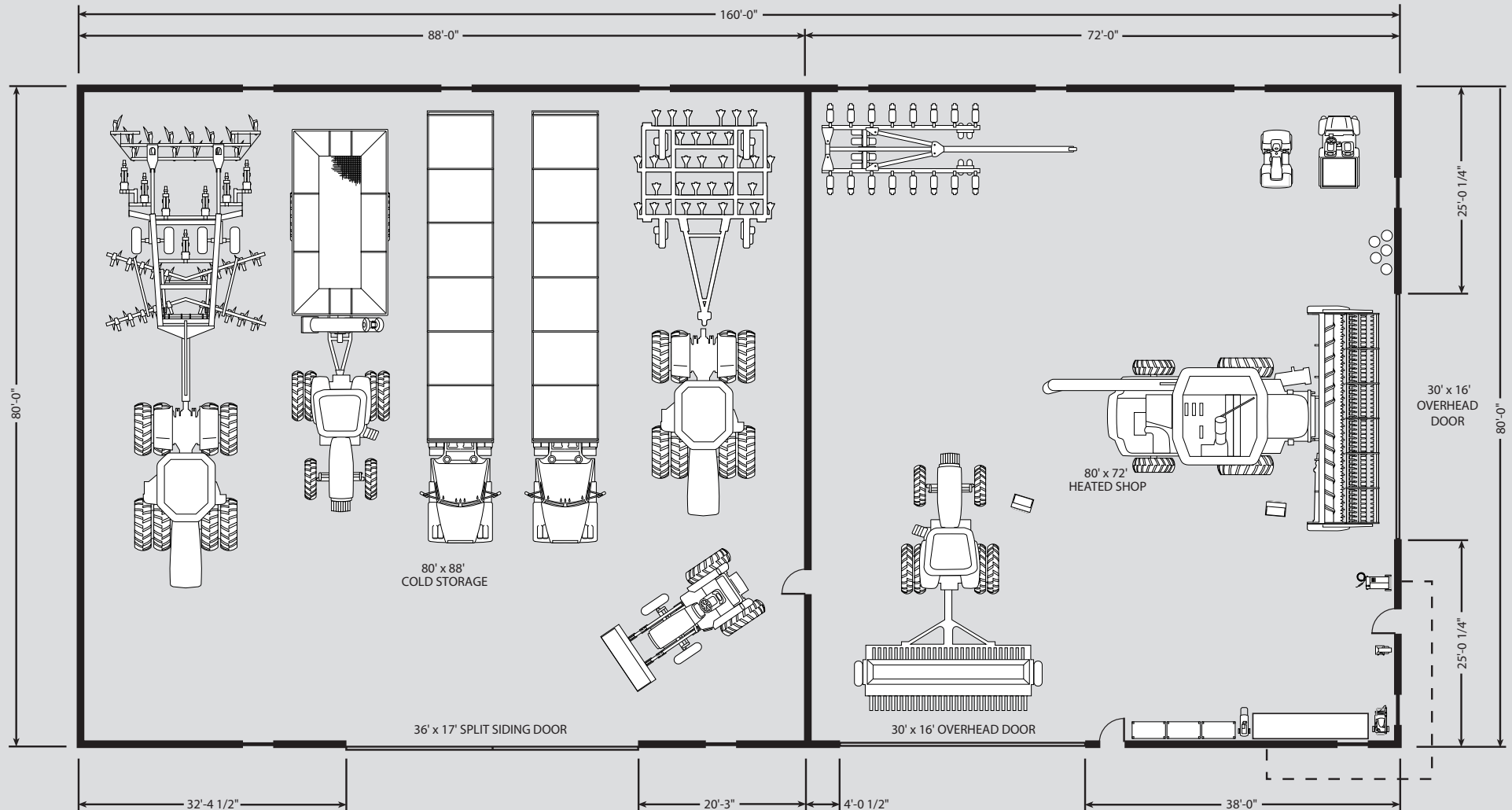

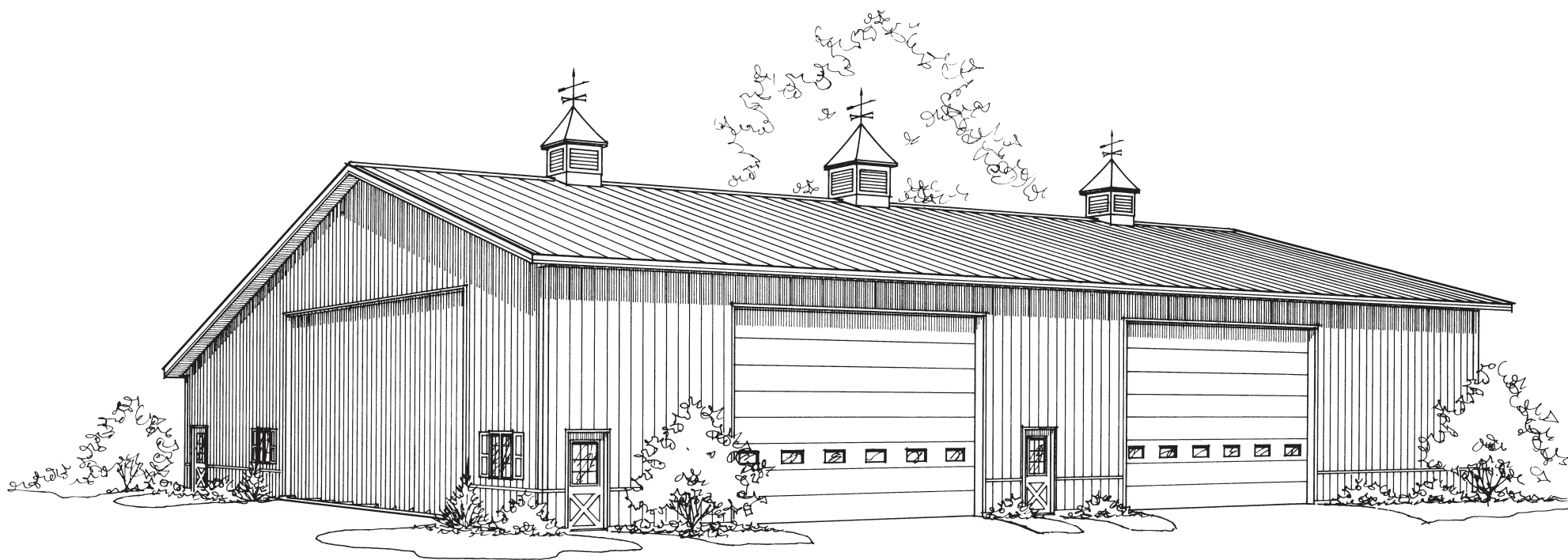

# Advanta Shop

## BIG DOORS BID WARM WELCOME TO OVERSIZED EQUIPMENT

Been eyeing the biggest, baddest combine your favorite manufacturer sells? Go ahead! You can even put on the extra big tires and grain extensions. This building can handle it, thanks to the Hydro-Swing® door. It's 40' of full-clearance, wide-open easy access to the roomy shop. Two good-sized overhead doors provide additional access. This building also features a lean-to portion with a stepped down ceiling. Some farmers prefer this because the lower ceiling is cozier and makes it easier to heat.





welcomes oversized equipment

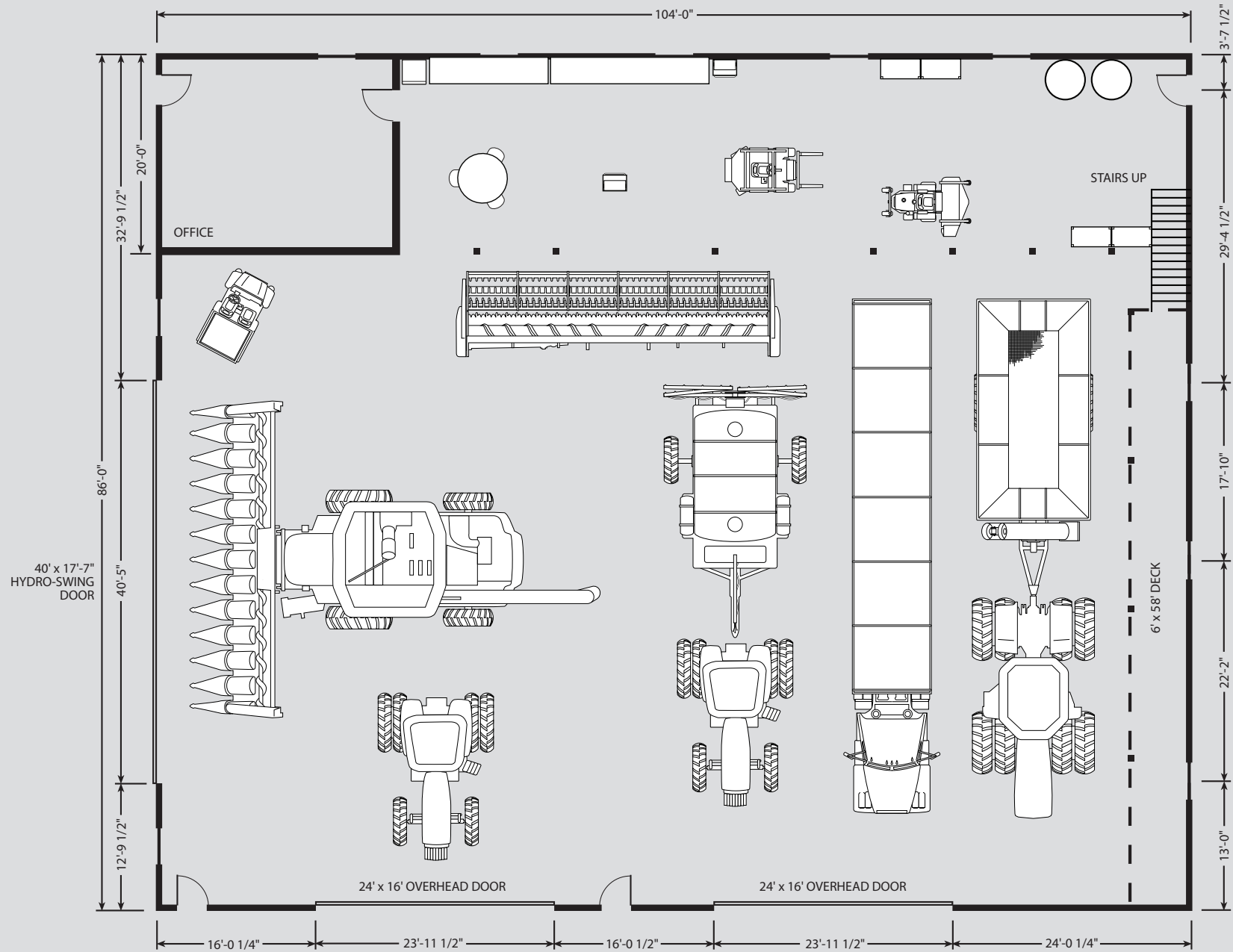



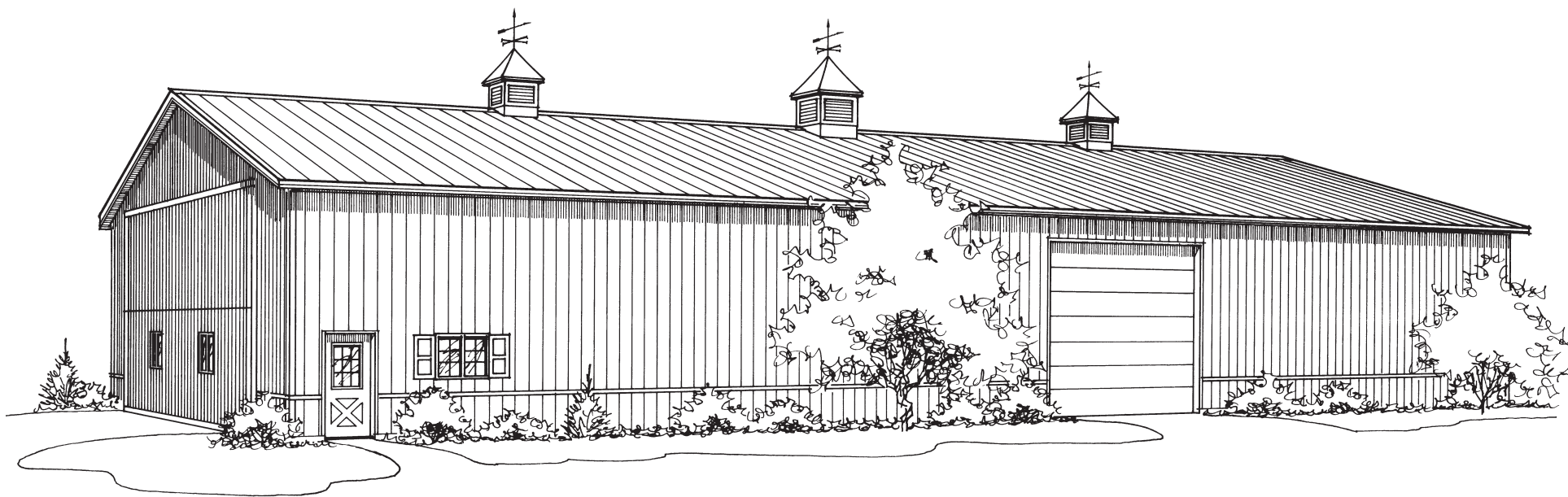

# Load 'em Up

## LINED UP AND READY FOR ACTION

The configuration of this building is ideal for the farmer who likes to strategically “load” his building so that when the huge 44' bi-fold door on the end opens, your implements can stream straight out in rapid fashion, off to the fields, one after another.





lined up and ready for action

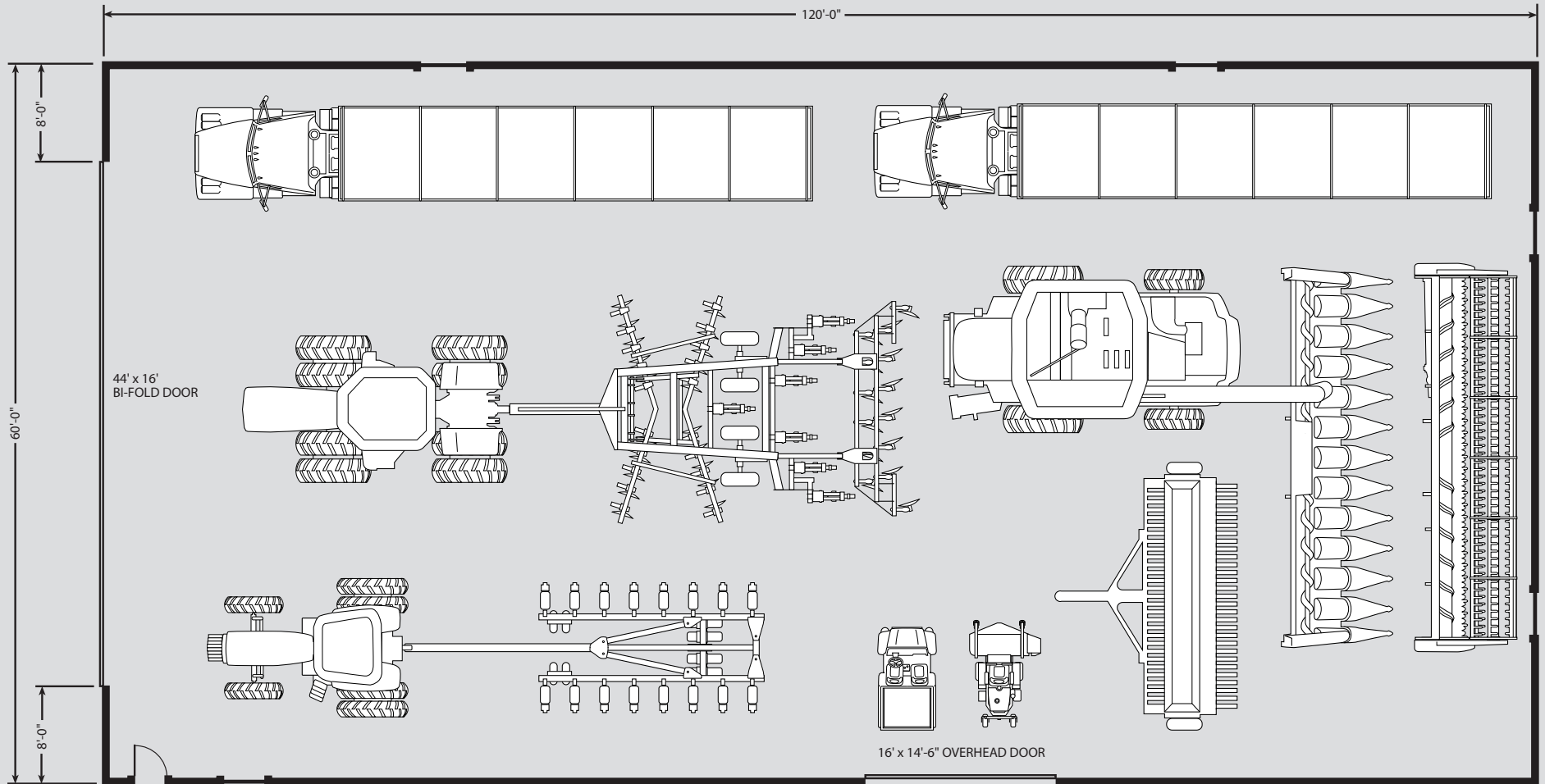

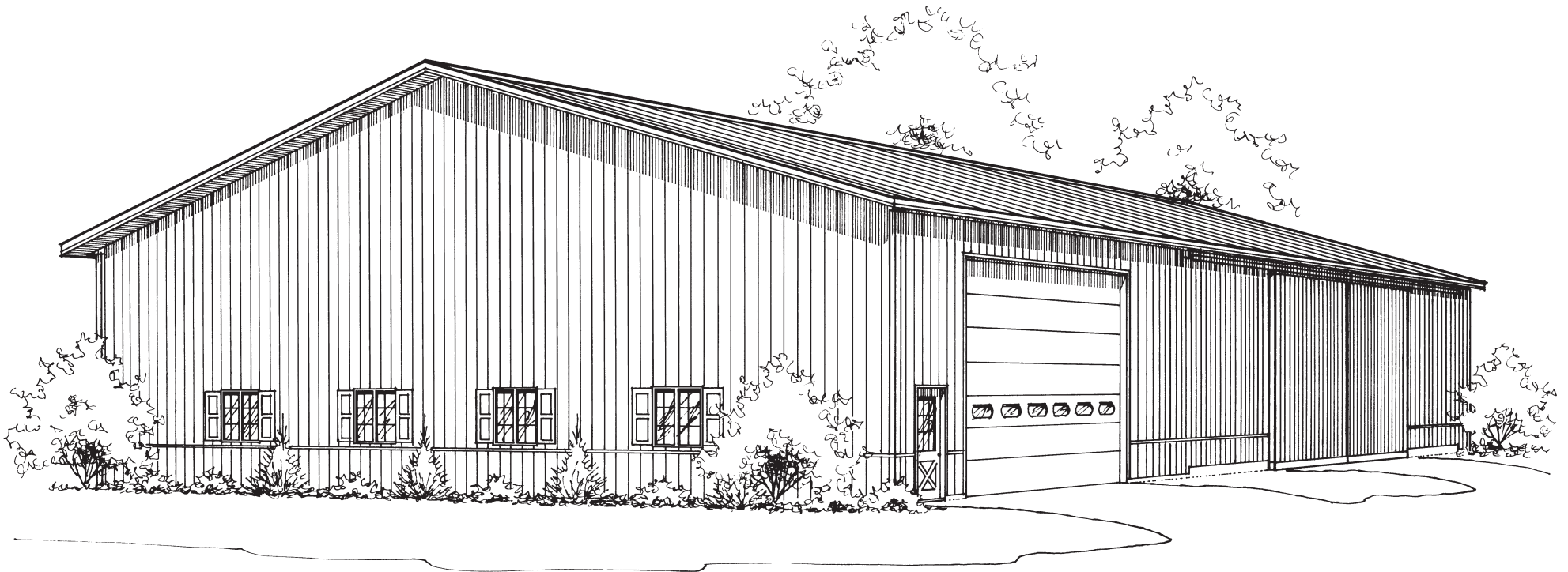

# The Farmhand

## AN INDISPENSABLE PART OF THE OPERATION

Like many of the men whose hard work powers the ag economy, a building is a dependable, "strong silent type" that proves itself day after day over the decades as an integral part of a successful operation. There's nothing flashy about this building, but this combo shop & storage building will shelter your equipment from the elements and give you a warm, dry place to work for generations to come.







an indispensable part of the operation

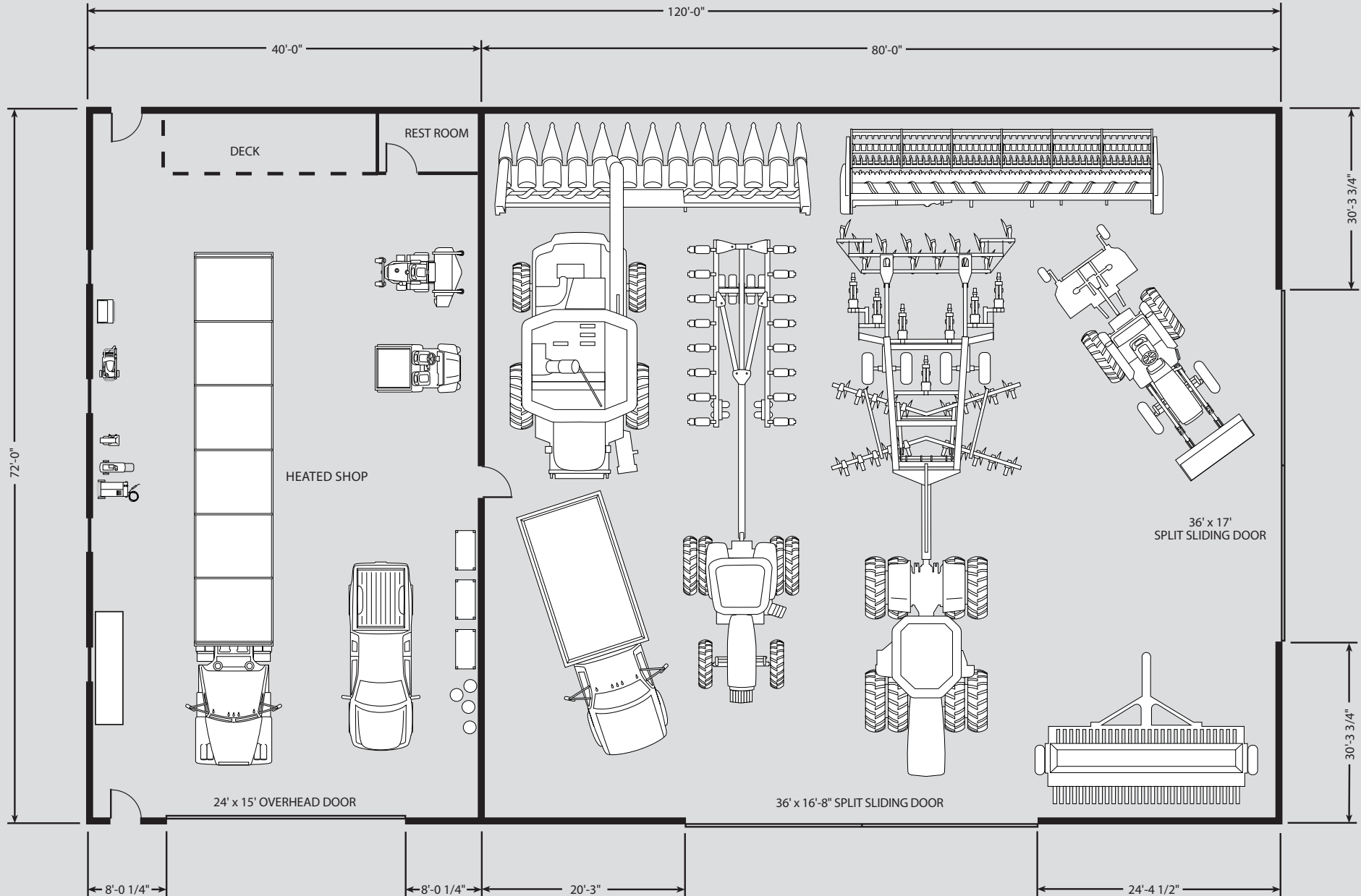

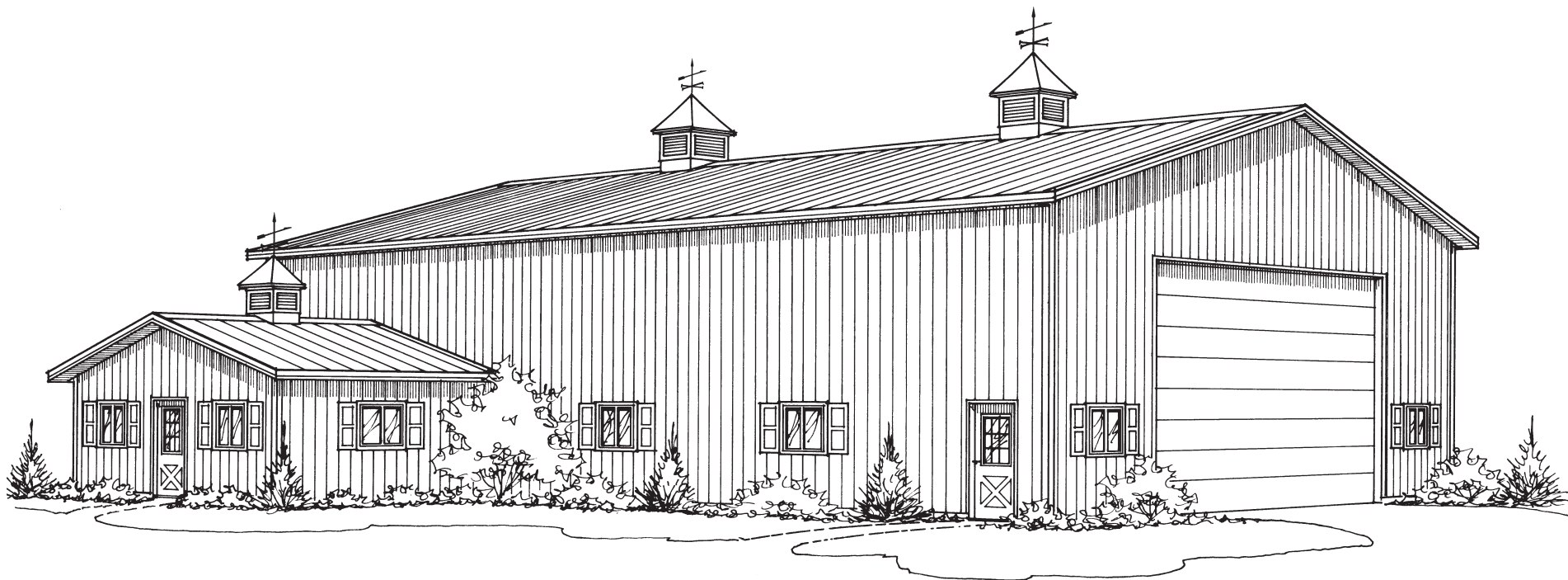

# Plowman Place



MORE THAN JUST A STANDALONE SHOP, this "L" shaped building boasts a separate office portion and useful multi-purpose room. That can come in handy for family gatherings, youth group activities or general storage. The shop includes two often-requested features: a deck and a rest room. Both can improve your efficiency!



more than just a standalone shop

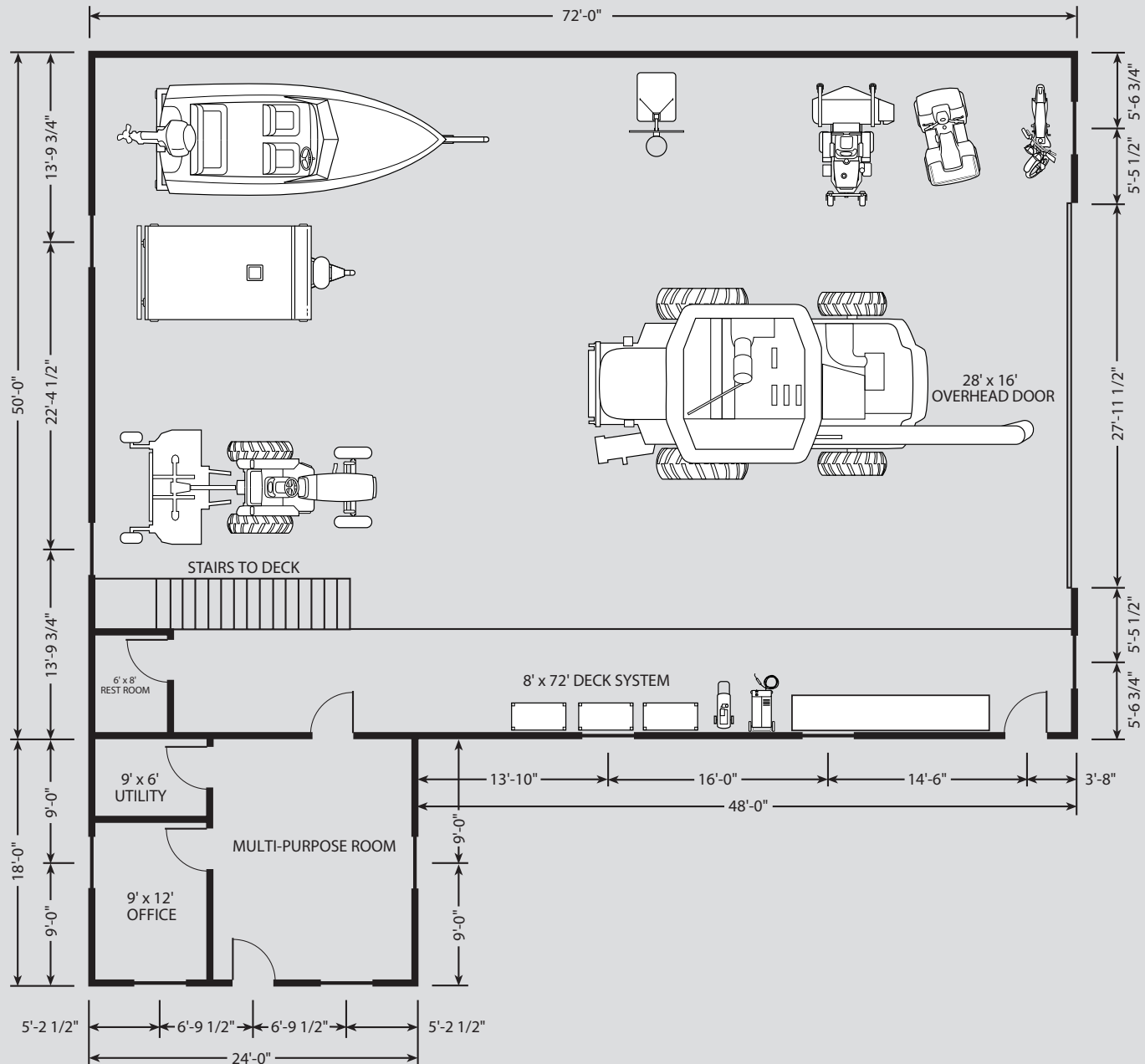





The renderings in this book are artistic renditions of completed FBi projects. Some modifications may have been made from the actual buildings.

© 2018 FBi Buildings, Inc.  
All Rights Reserved



# Start Your Design Online

Design your building in 3D with our improved FBiPlanner tool.



Available exclusively on **[www.fbibuildings.com](http://www.fbibuildings.com)** is a **FREE**, powerful application that lets you design your own building using scaled icons of almost anything you're likely to put in a building – vehicles, farm equipment, building components and more.

## With the FBiPlanner tool you can:

- Resize, rotate, and moved scaled icons of vehicles, equipment, etc.
- Verify door locations and sizes
- Make sure your stuff fits and decide where to put it
- Add different building features, such as: windows, doors, cupolas, eavelights and porches.
- Save, print and Email your plans

Go to **[www.fbibuildings.com/getting-started/design-your-own/](http://www.fbibuildings.com/getting-started/design-your-own/)** to start designing your new building today!



3823 W 1800 S Remington, IN 47977

(800) 552-2981 | [FBiBuildings.com](http://FBiBuildings.com)